

INDEX
By Section

*Click on the desired Installation Guide to jump to the Guide page.

Product Name	Product Code	Guide No.	Last Updated
WORKSURFACE SUPPORT & ACCESSORIES			
Modesty Panel	ACMP	266	May 2018
WORK TABLES			
Rectangular Table (Ability)	AWRE	311	Jan 2019
Racetrack Table (Ability)	AWRA		
PARTNER TABLES			
Hoola (Ability)	APHO	321	Jan 2019
Dew (Ability)	APDE		
Blink (Ability)	APBL		
TABLE ACCESSORIES			
Table Tray (Ability)	ACTT	331	May 2018
MOUNTED STORAGE & ACCESSORIES			
Montor Screen	ACMS	407	May 2018

Product Name	Product Code	Guide No.	Last Updated	Product Name
--------------	--------------	-----------	--------------	--------------

Product Code	Guide No.	Last Updated
--------------	-----------	--------------

Modesty Panel (ACMP)

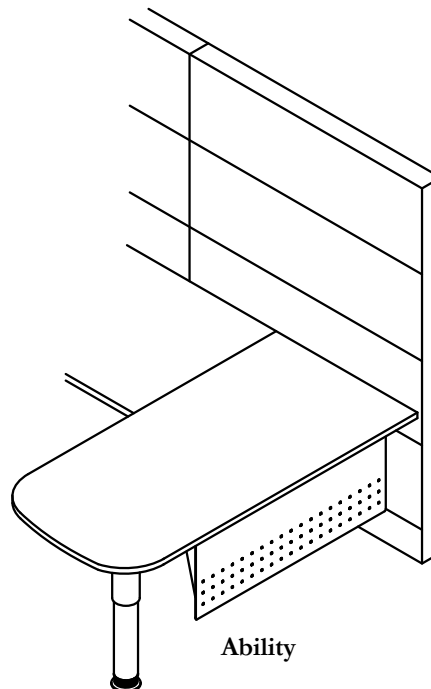
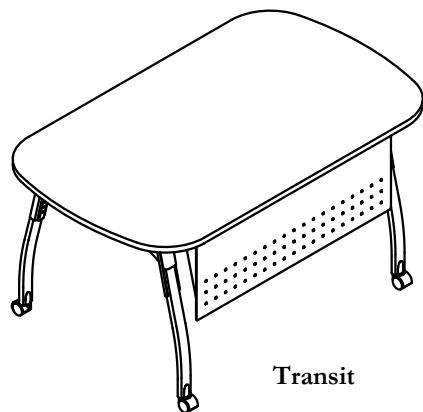
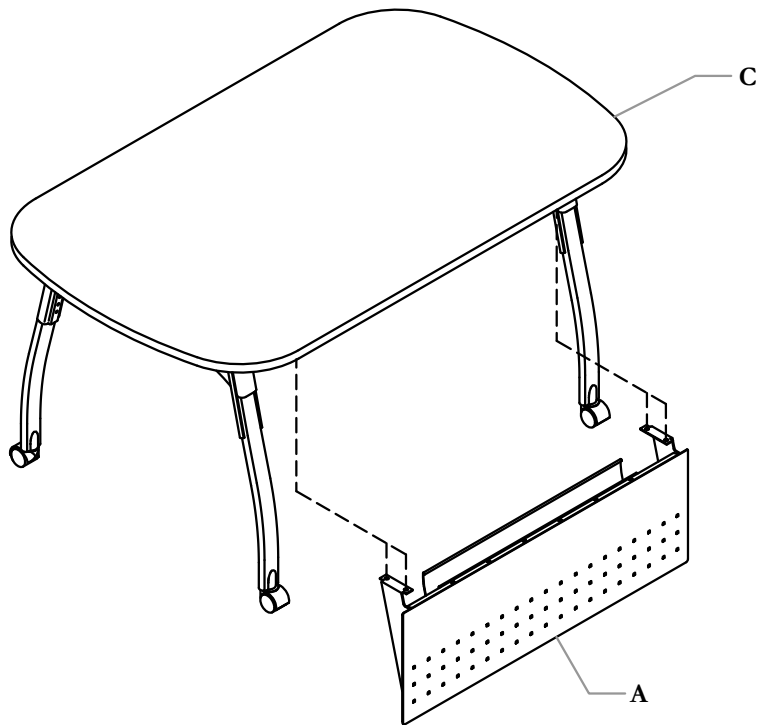

Part and Product Identification

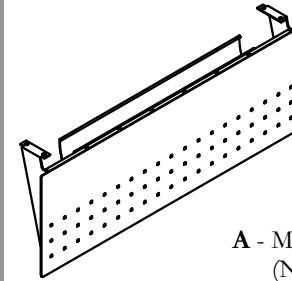

A - Modesty Panel & Tray Assembly
(N62-0002) x1



B - Quadrex, Pan Washer Head Machine
Screw, Zinc plated
(E07-0077) x1

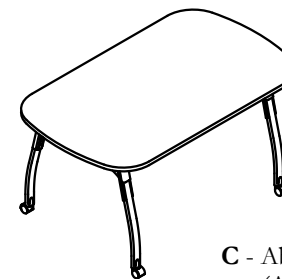

C - Ability Table or Transit Worksurface
(As per order) x1

MODESTY PANEL INSTALLATION

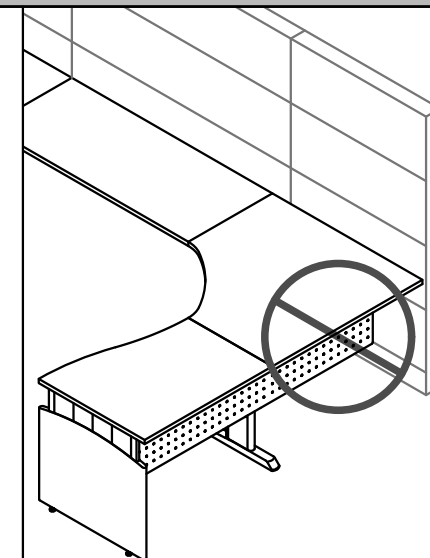
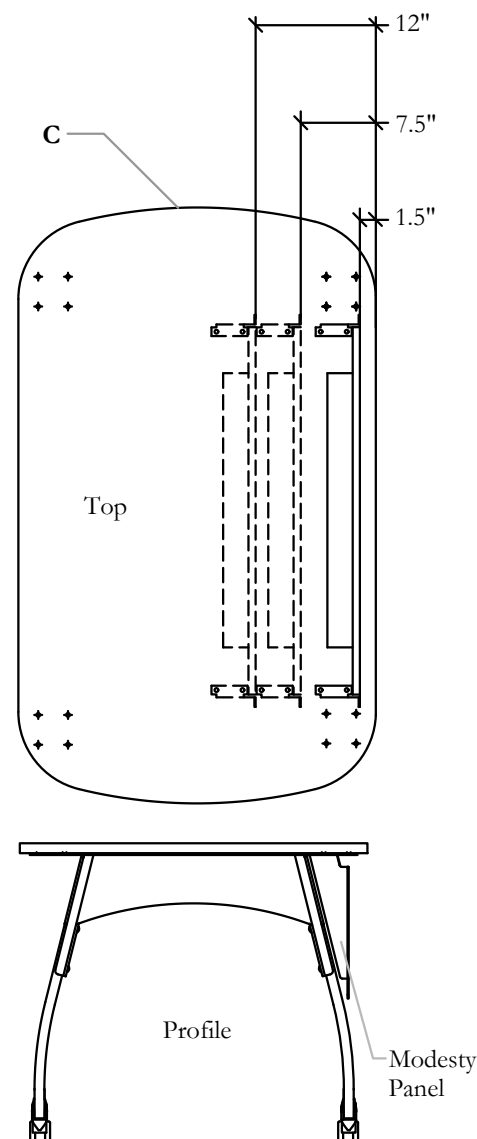
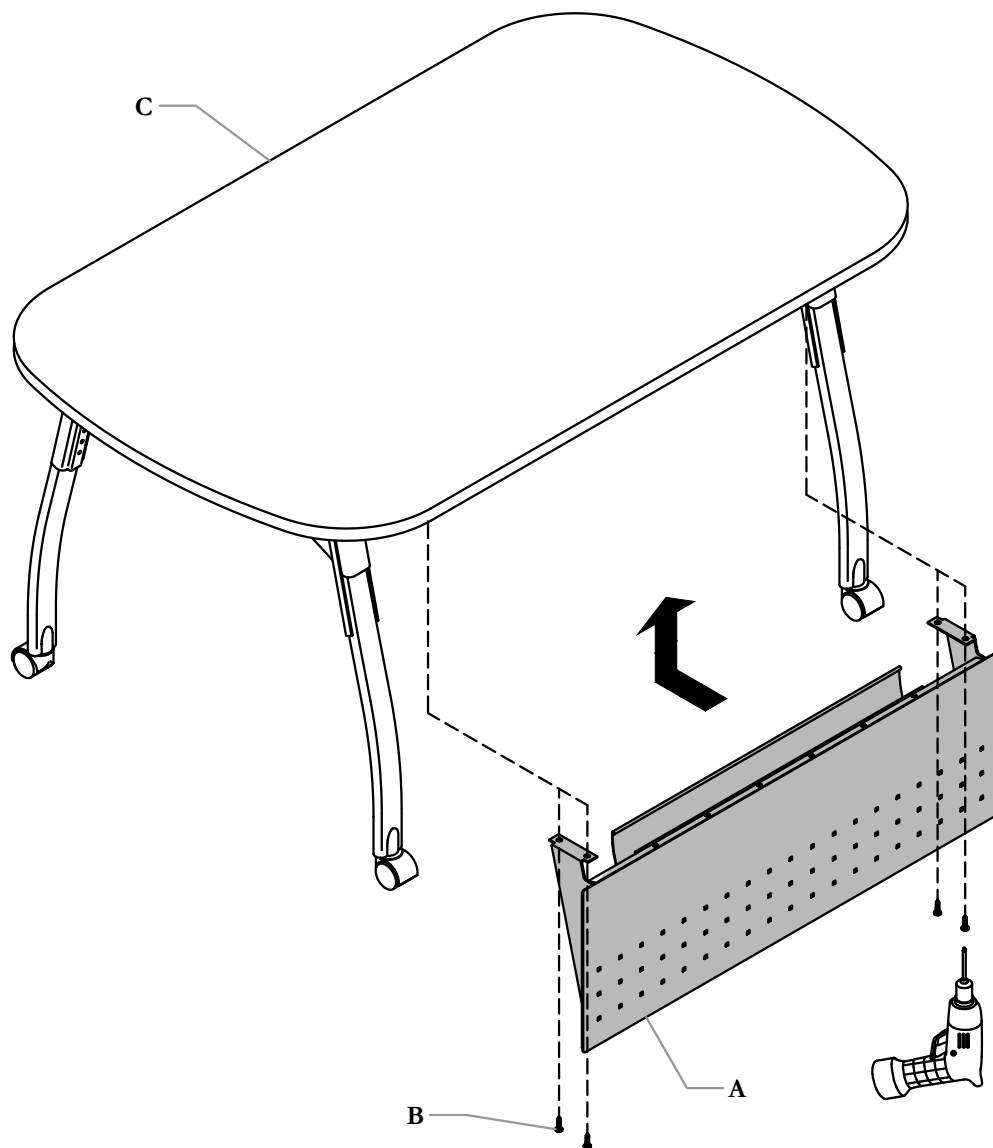

Modesty Panel cannot be installed
across Worksurface Supports!

ONE MODESTY PANEL PER
WORKSURFACE MUST BE
SPECIFIED

STEP 1: Installation Position from Worksurface Rear Edge!

- 1.5" - Individual modesty position
- 7.5" - Guest modesty position
- 12" - Shared/Managerial modesty position
(on 36" depth worksurface only)

Section: **WORK TABLES**

Description: **WORK TABLES INSTALLATION FOR ABILITY AND TRANSIT**

Rectangular Table (AWRE) & Racetrack Table (AWRA)

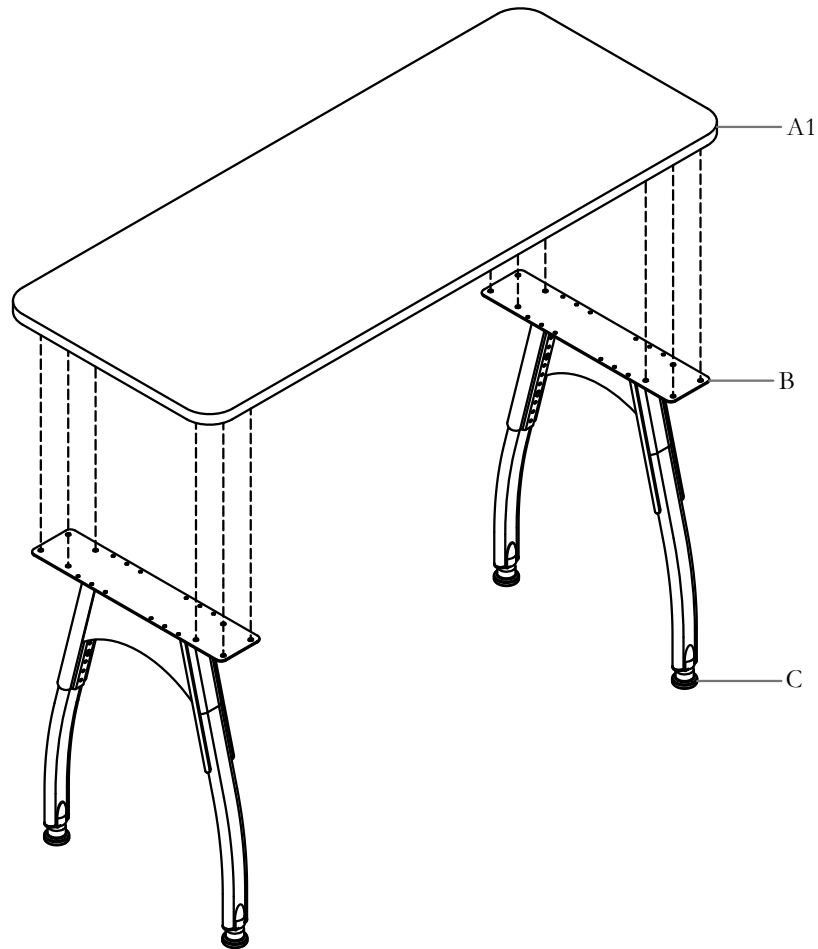

Rectangular Worksurface shown as example

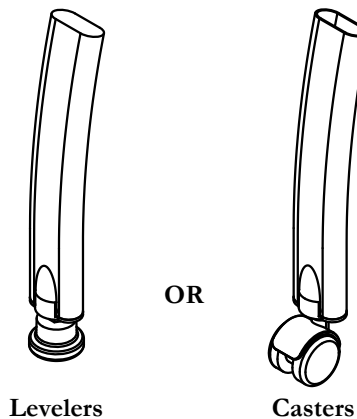

Part and Product Identification

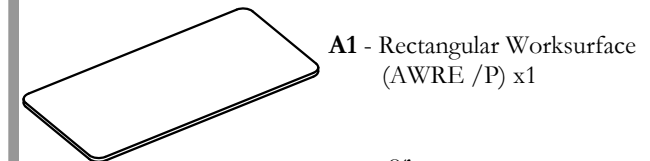

A1 - Rectangular Worksurface
(AWRE /P) x1

or

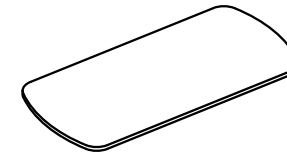

A2 - Racetrack Worksurface
(AWRA /P) x1

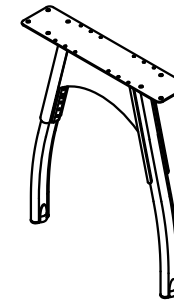

B - Dual Leg Assembly
(N66-4023X) x2

OPTIONS:

C - Casters/Levelers



C1 - Casters
(D06-4059) x4

or



C2 - Lockable Casters
(D06-4060) x4

or



C3 - Leveler (Glide)
(D06-4000) x4

D - (X66-4011) x2 Kits



D1 - 1/4"-20 x 5/8" UNC. Quadrex
Truss Hd, Machine Screw
(E01-0098) x8



D2 - #10 x 0.875" Quadrex, Pan
Washer Hd, Tap Screw, Zinc
(E07-0077) x12

FASTEN LEG ASSEMBLY

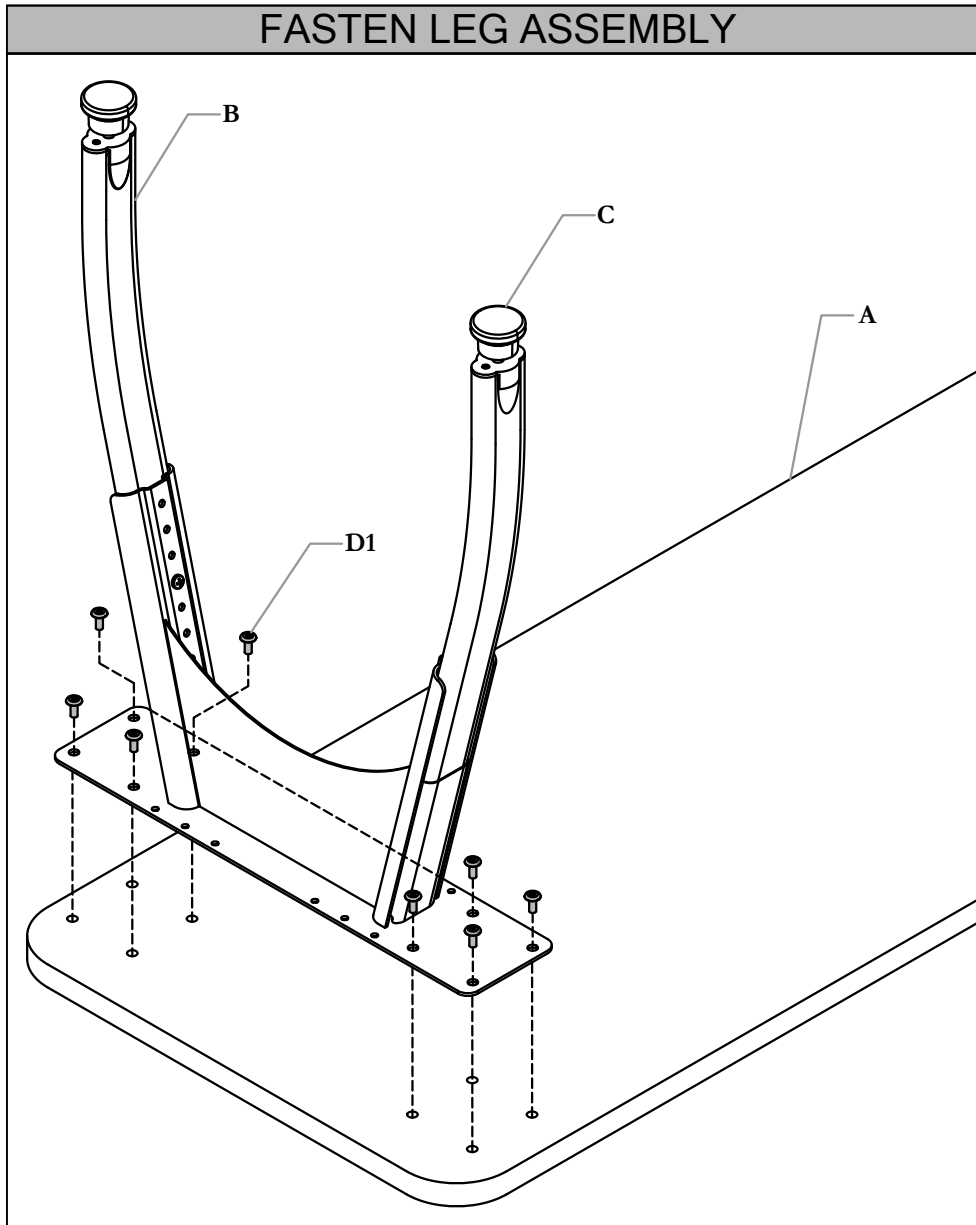

STEP 1: Install Leg Assembly onto the Worksurface with the Screws provided on both sides.

SECURE LEG ASSEMBLY

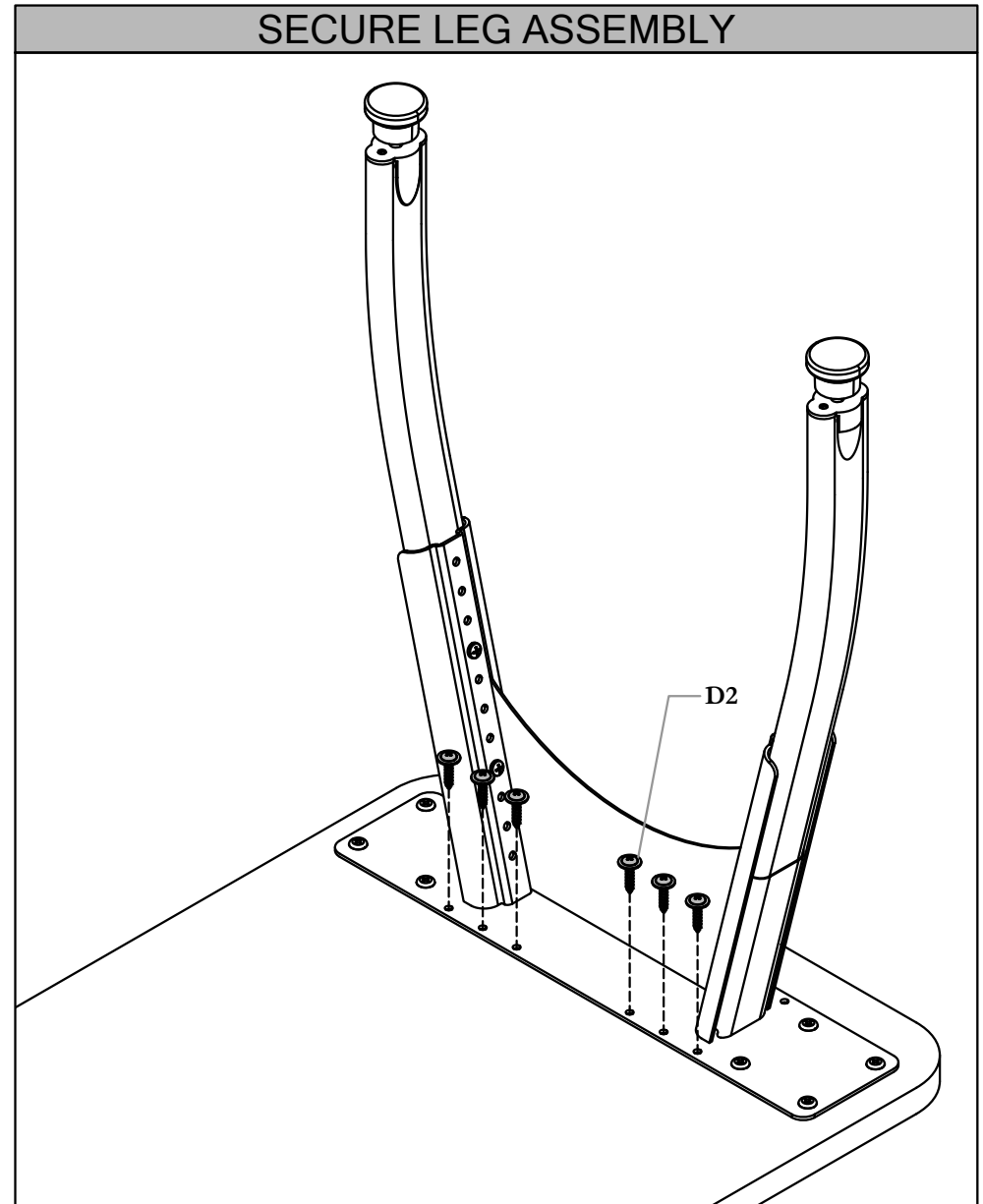

STEP 2: Fasten the Leg Assembly with the Wood Screw that's provided as shown above on both sides.

REMOVE SCREWS

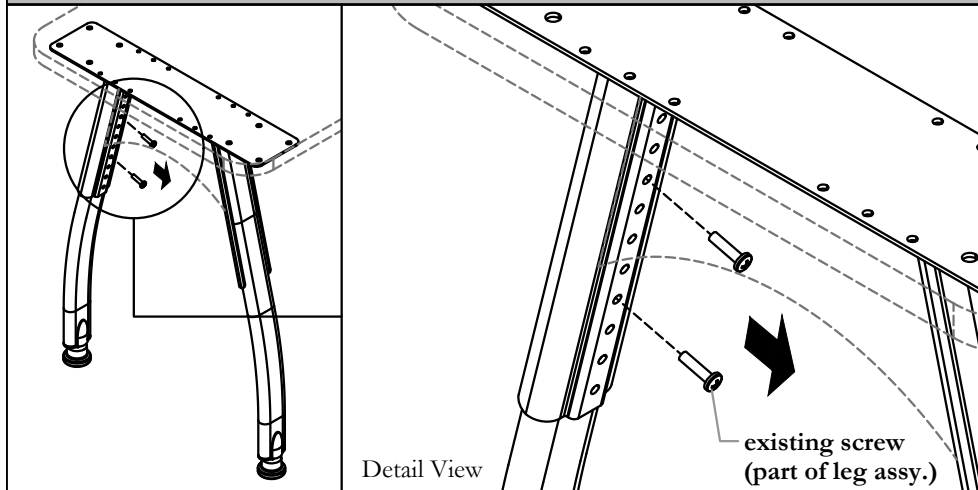

STEP 3: To adjust the height of the table remove two screws on legs.

CHANGE HEIGHT

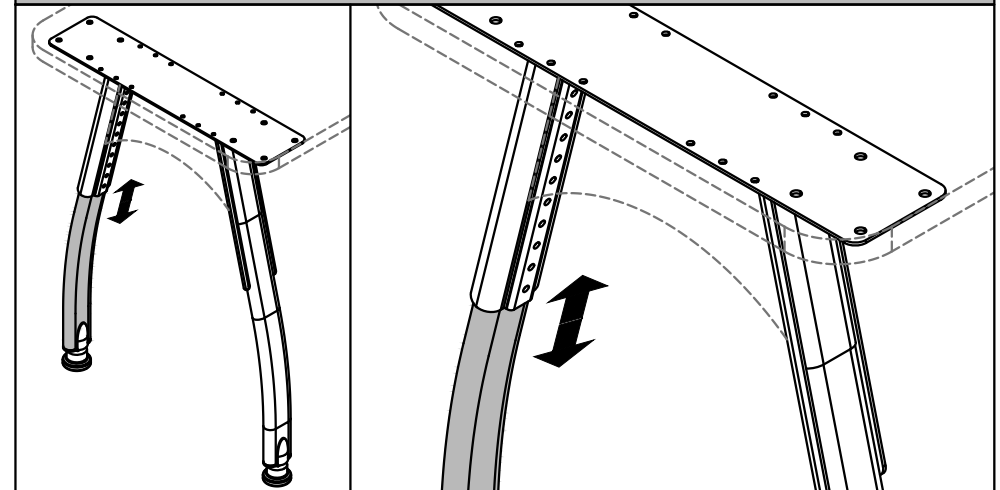

STEP 4: Adjust leg either up or down to a desired height.

FASTEN SCREWS

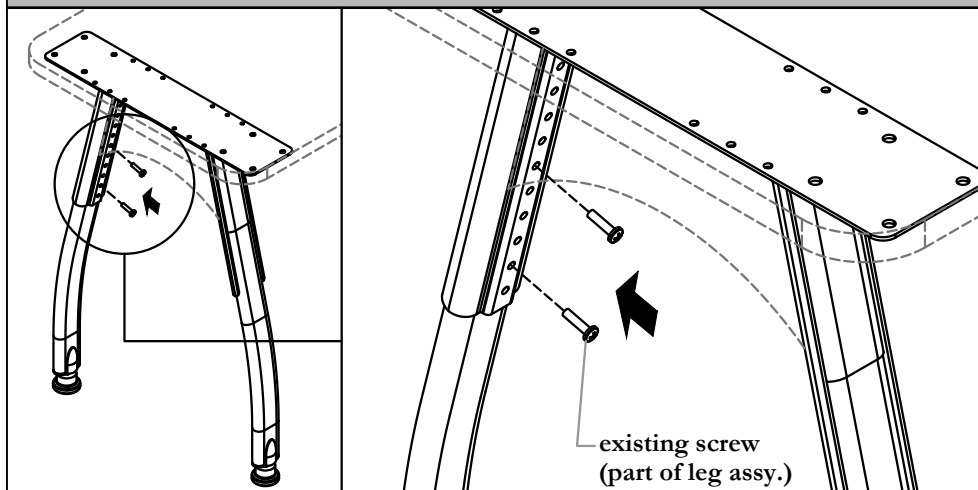

STEP 5: Fasten previously removed screws back onto the leg assembly.

CASTER INSTALLATION

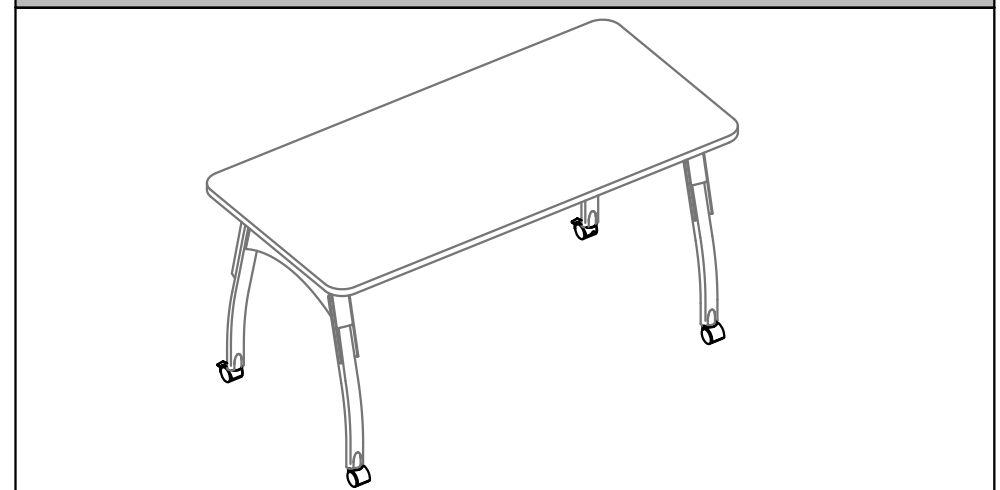

STEP 6: Installing Casters.

REMOVE GLIDE

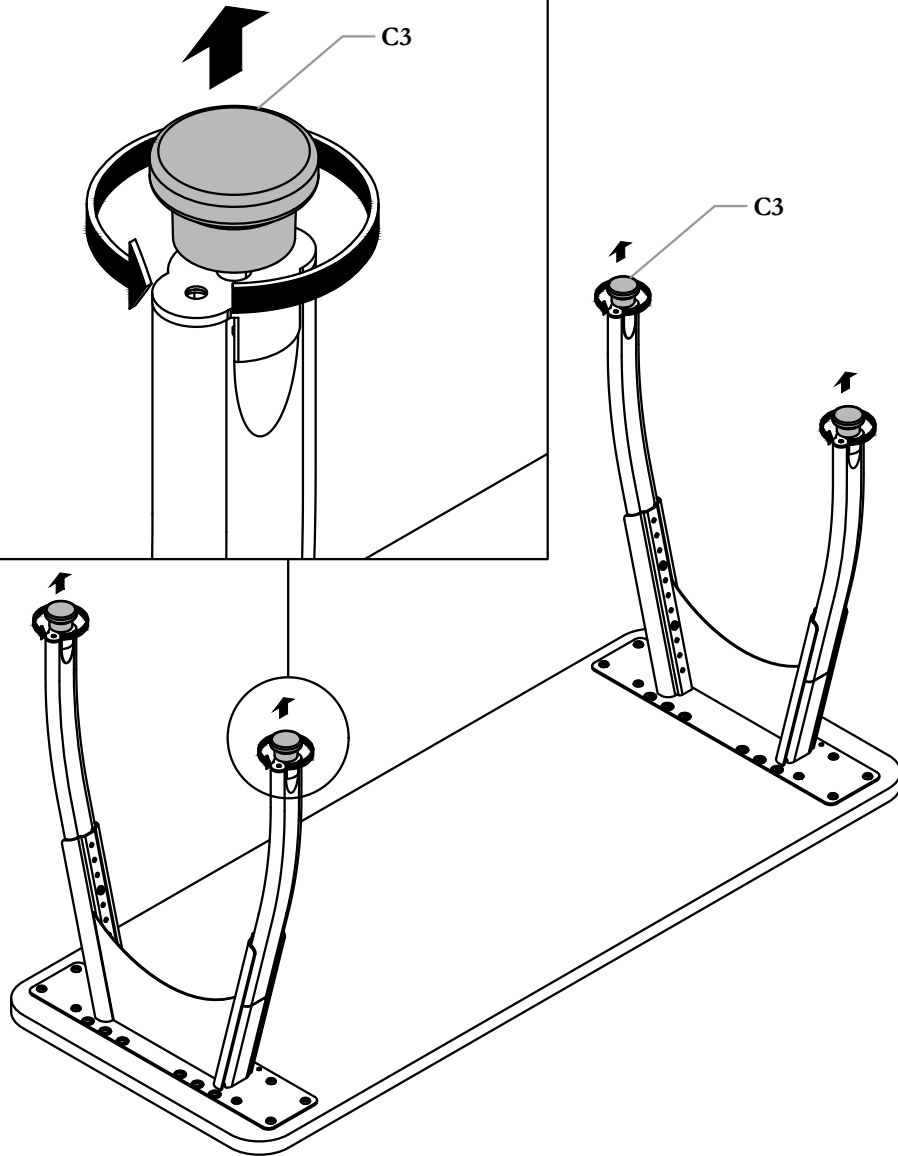

STEP 7: Remove four Leveler by rotating the leveler counter clockwise.

INSTALL CASTER

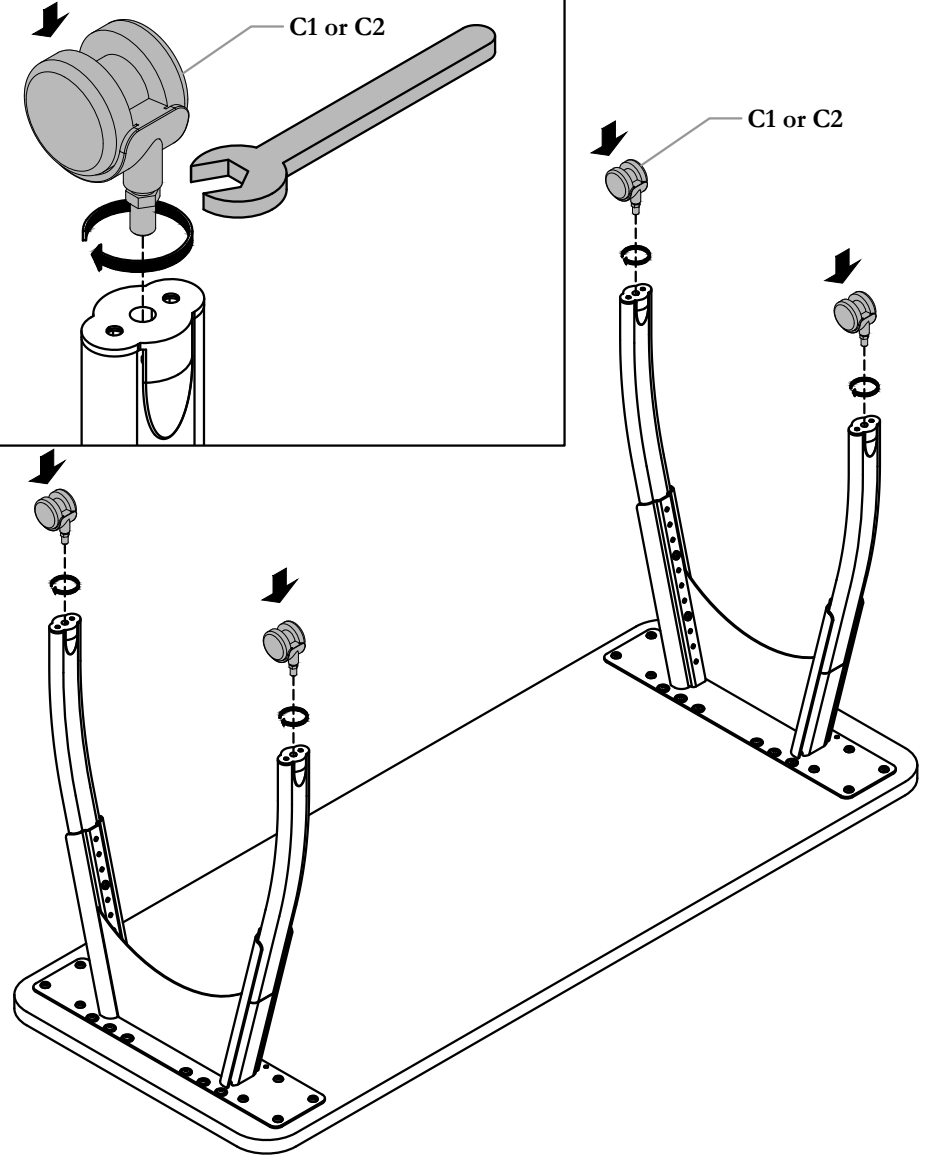

STEP 8: Install four Casters onto the leg assembly, as shown above.

Section: **PARTNER TABLES**

Description: **PARTNER TABLES INSTALLATION**

Hoola Table (APHO), Dew Table (APDE) & Blink Table (APBL)

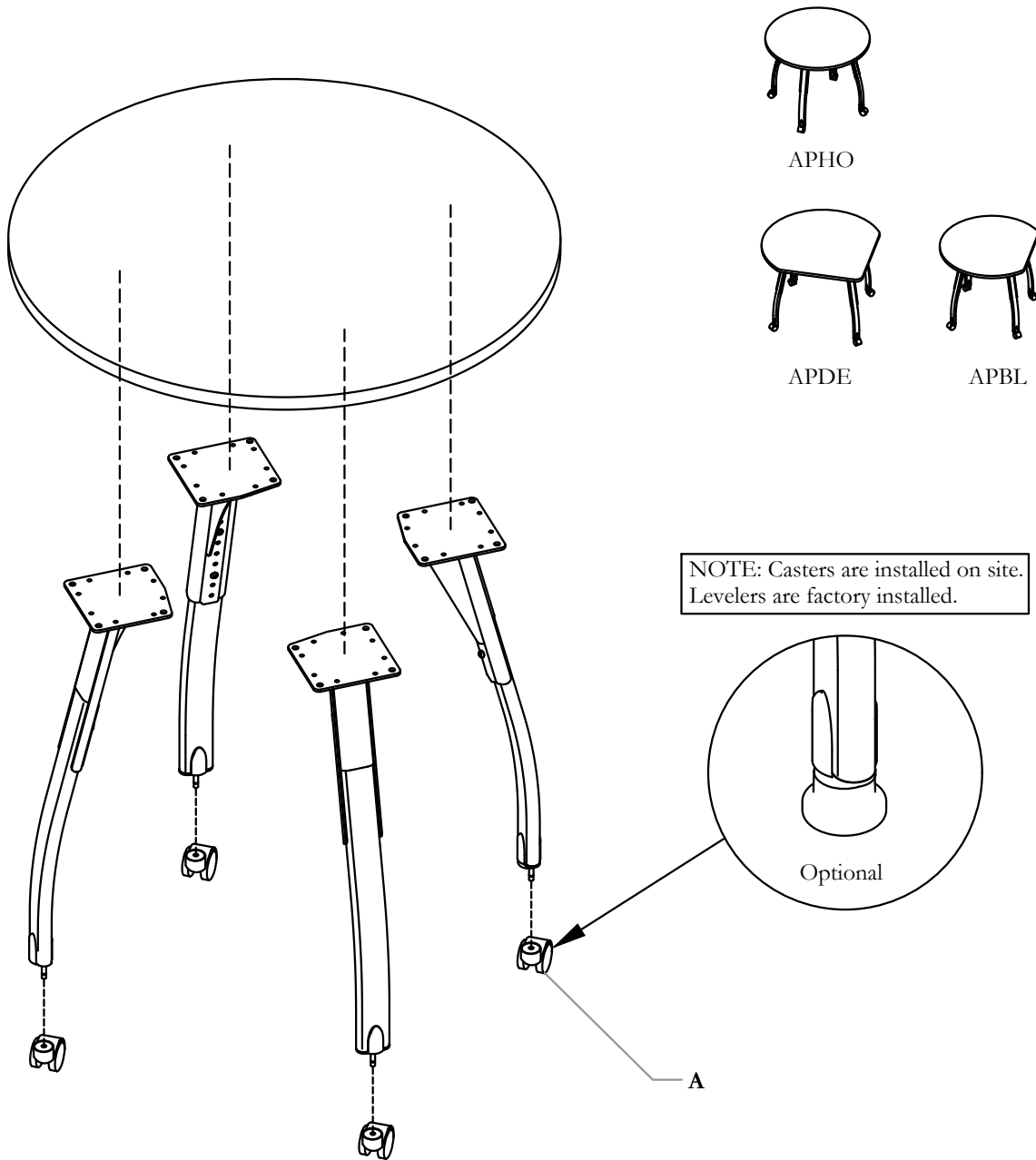

Part and Product Identification



A - Caster
(D06-4001) x4

OR



Lockable Caster
(D06-4006) x4

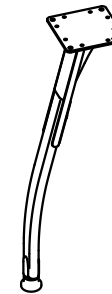

B - Single Leg Sub-Assembly
(N66-4024)
Left x2
Right x2

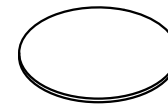

C - Hoola Worksurface
(APHO) x1

OR

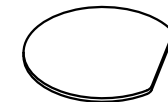

Blink Worksurface
(APBL) x1

OR



Dew Worksurface
(APBL) x1

D - Hardware Kit
(X66-4011) x2



D1 - 1/4"-20 x 5/8" UNC
Cross/Square Comb
Truss Head M Screw
(E01-0098) x8



D2 - #10 x 0.875" Quadrex
Tap Screw. Pan Washer Hd
(E07-0077) x12

Section: **PARTNER TABLES**

Description: **PARTNER TABLES INSTALLATION**

Date: Jan 2019 Page No: 2 of 4
TST_321

HOLE PATTERN

HOLE PATTERN - HOOLA

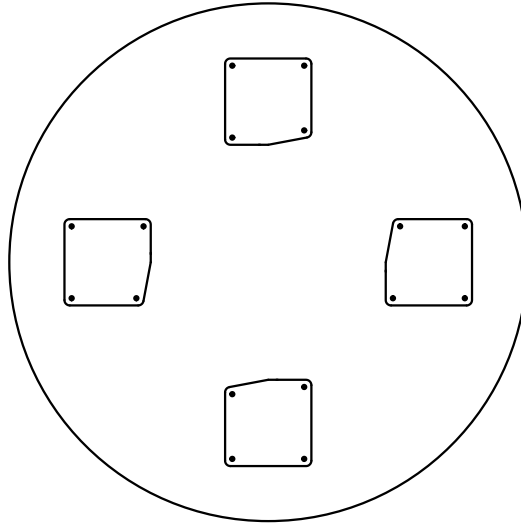

HOLE PATTERN - DEW & BLINK

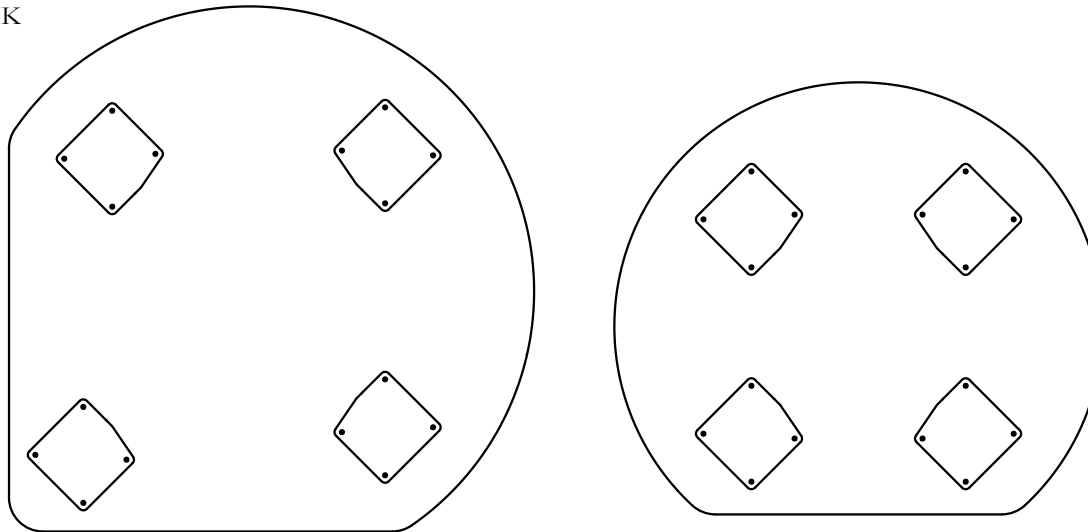

STEP 1: Identify the hole pattern prior to installation.

FASTEN LEGS WITH MACHINE SCREW

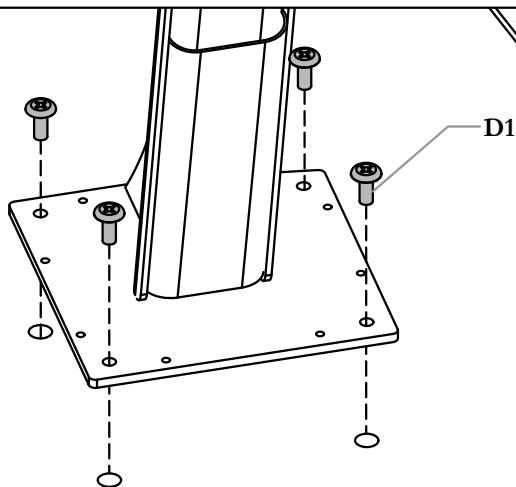
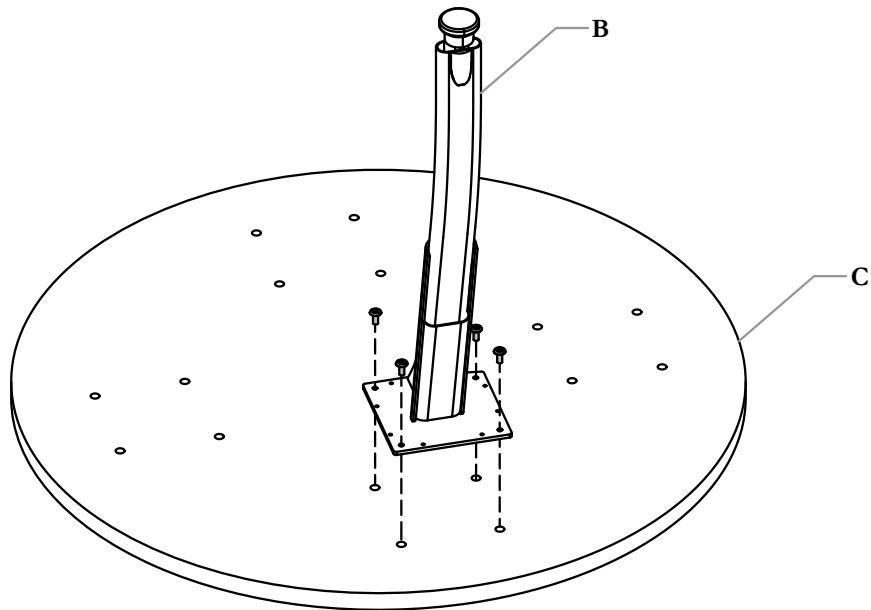

STEP 2: Install all four legs with Machine Screws provided.

FATSEN LEGS WITH WOOD SCREWS

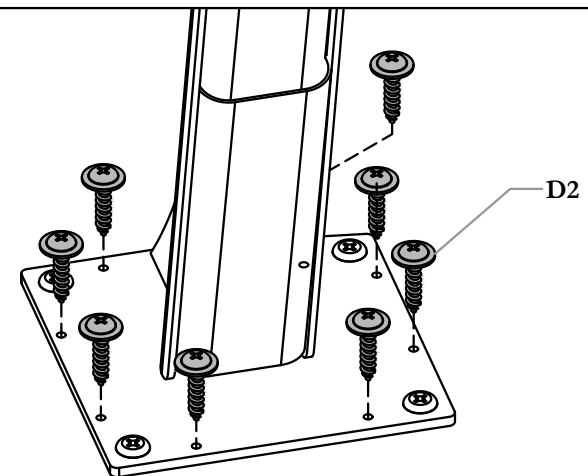
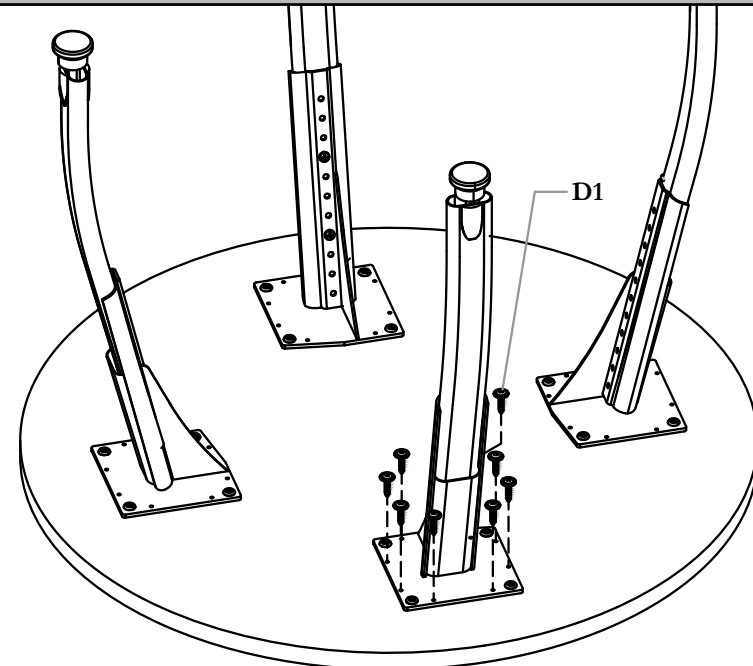

STEP 3: Secure all four legs with Wood Screws provided

ADJUST LEGS

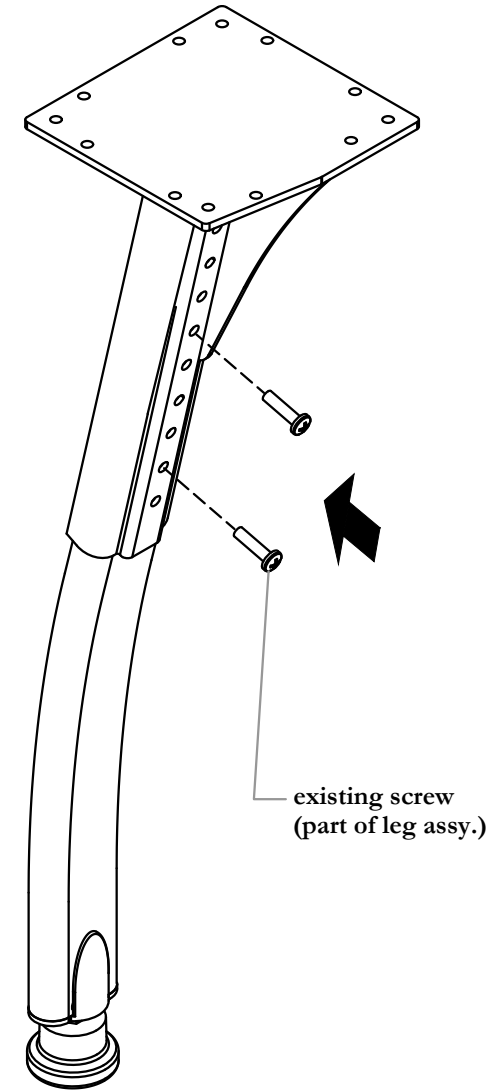
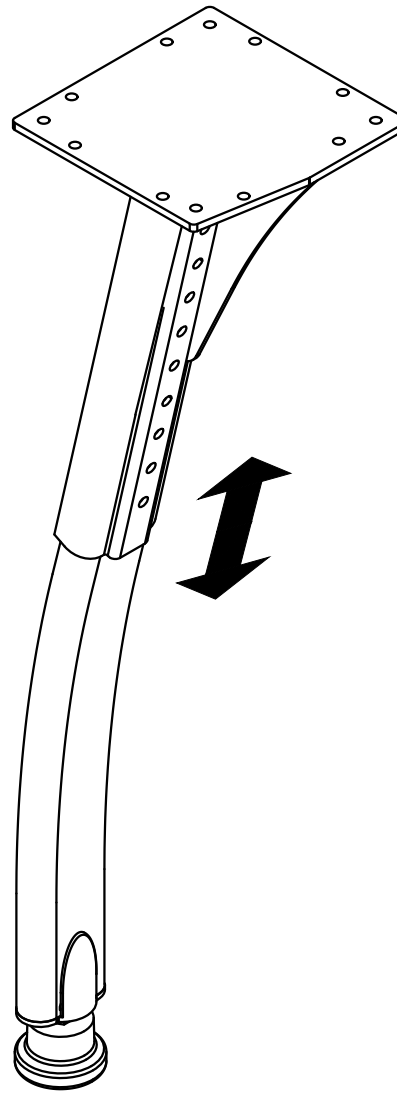
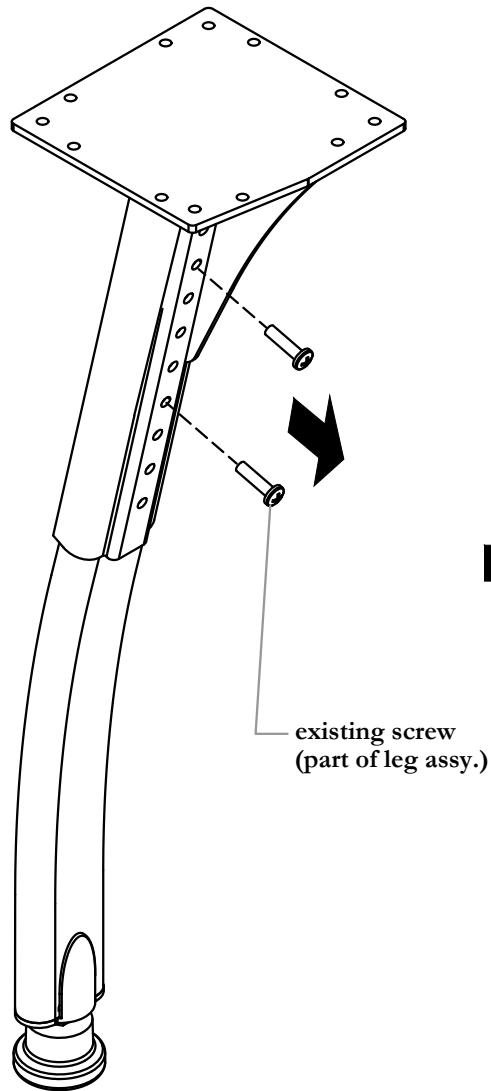

STEP 4: Remove Screw to loosen the legs. Adjust legs to desired height. Install Screws back into the Leg Assembly.

Section: **ABILITY TABLE ACCESSORIES**

Description: **TABLE TRAY FOR ABILITY AND TRANSIT**

Table Tray (ACTT)

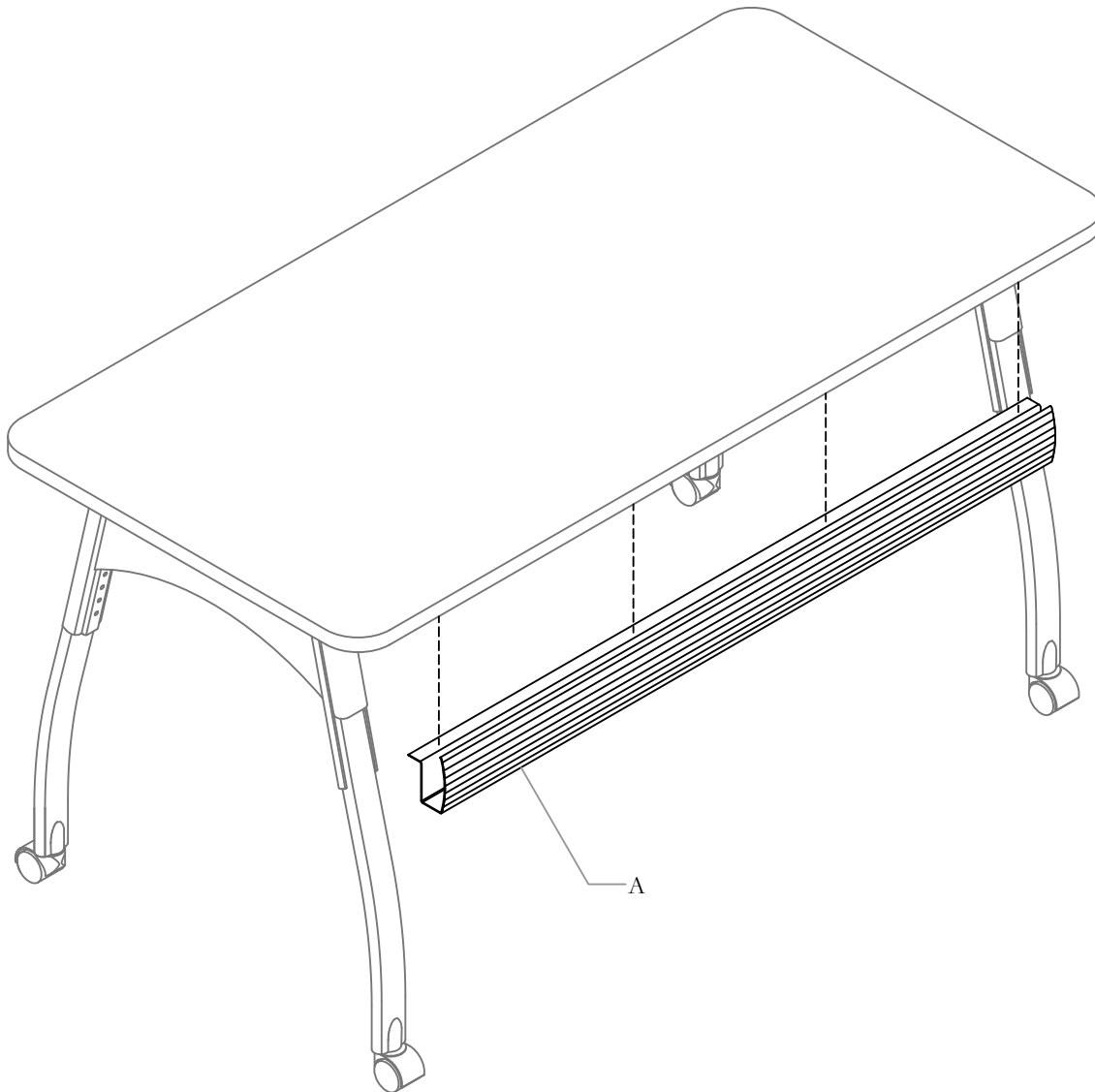

Part and Product Identification

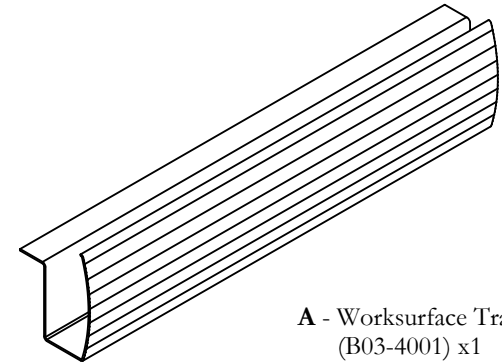

A - Worksurface Tray
(B03-4001) x1



B - #10x0.875" LG.
Screw. Pan Washer head
(E07-0077) x1

IDENTIFY LOCATION

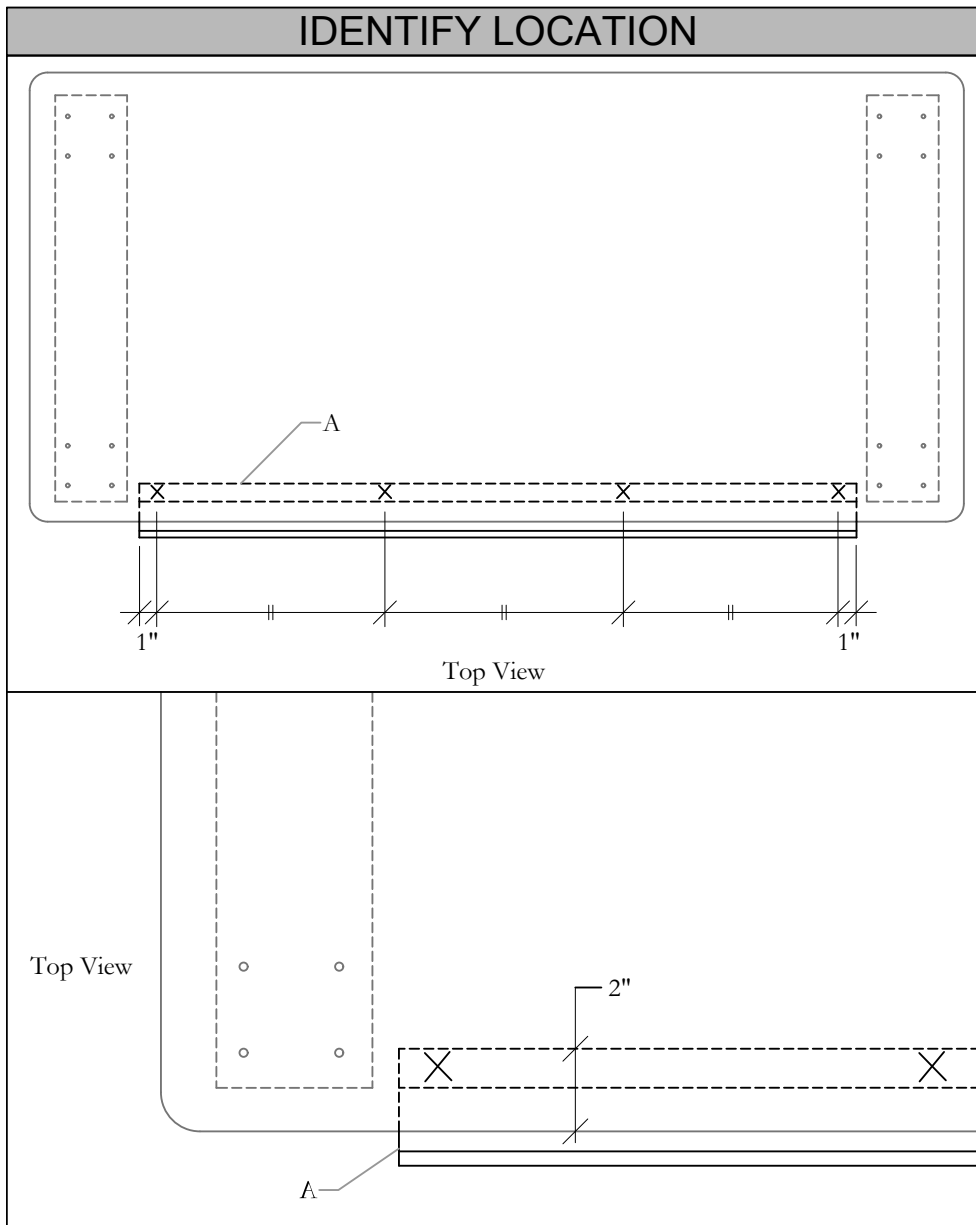

STEP 1: Identify the location of the Table Tray and the Wood Screw.

INSTALL TABLE TRAY

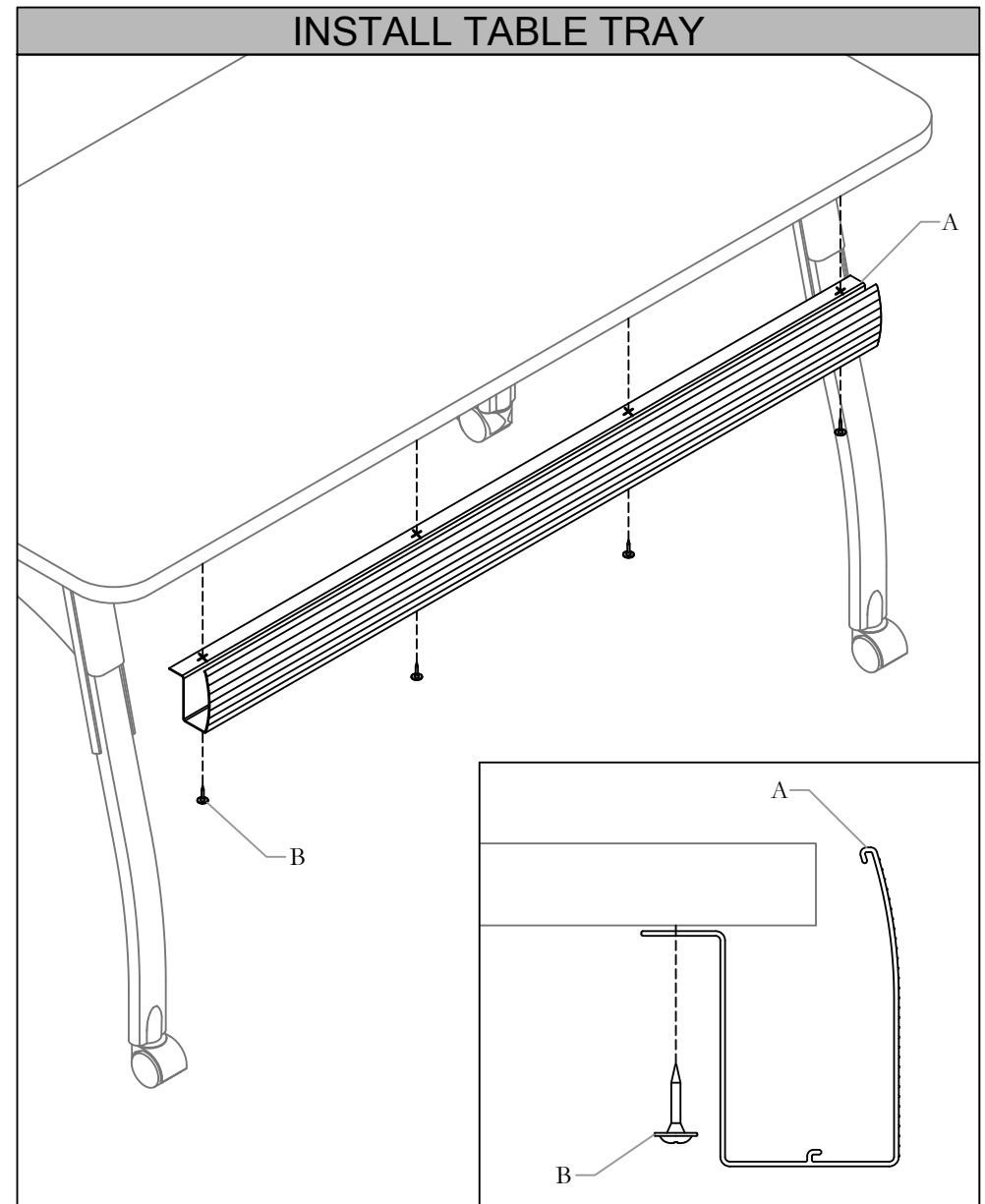

STEP 2: Install Table Tray by fastening it under the worksurface with Wood Screw provided.

Monitor Screen (ACMS)

Ability Section: TABLE ACCESSORIES

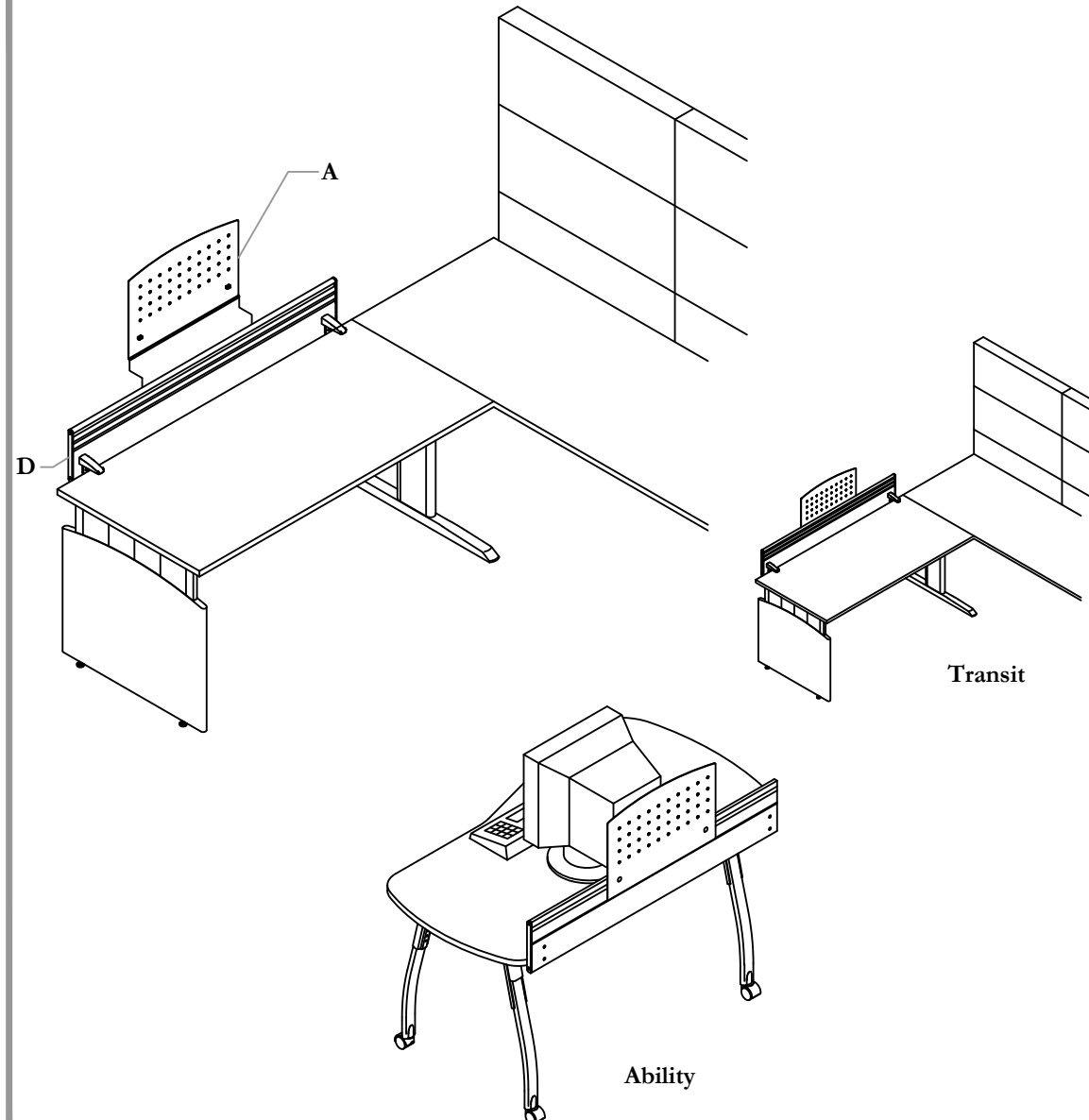

Part and Product Identification

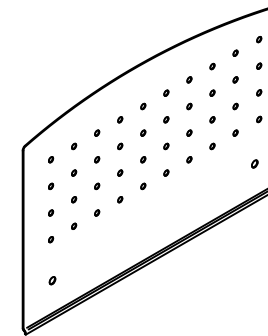

A - Monitor Screen
(ACMS) x1

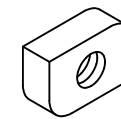

B - Monitor Screen T-Nut
(A25-2006) x2



C - 1/4" - 20 x 3/8" Hex Socket
Flat Head Cap Screw
(E01-2025) x2

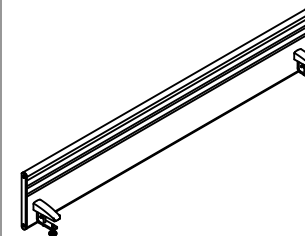

D - Table Rail
(ACTR) x1

INSTALL T-NUT

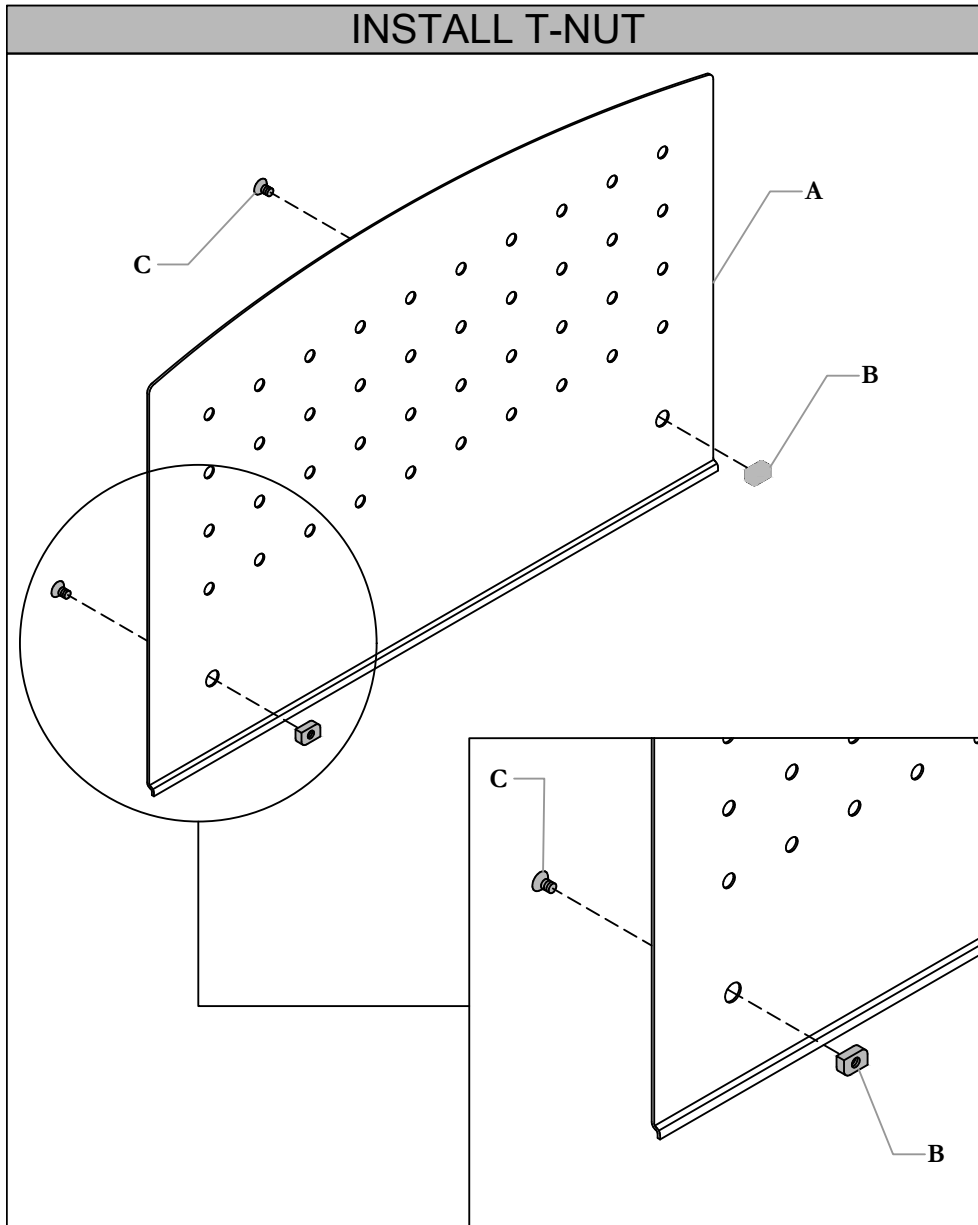

STEP 1: Install T-Nut with Screws provided as shown above.

INSTALL MONITOR SCREEN

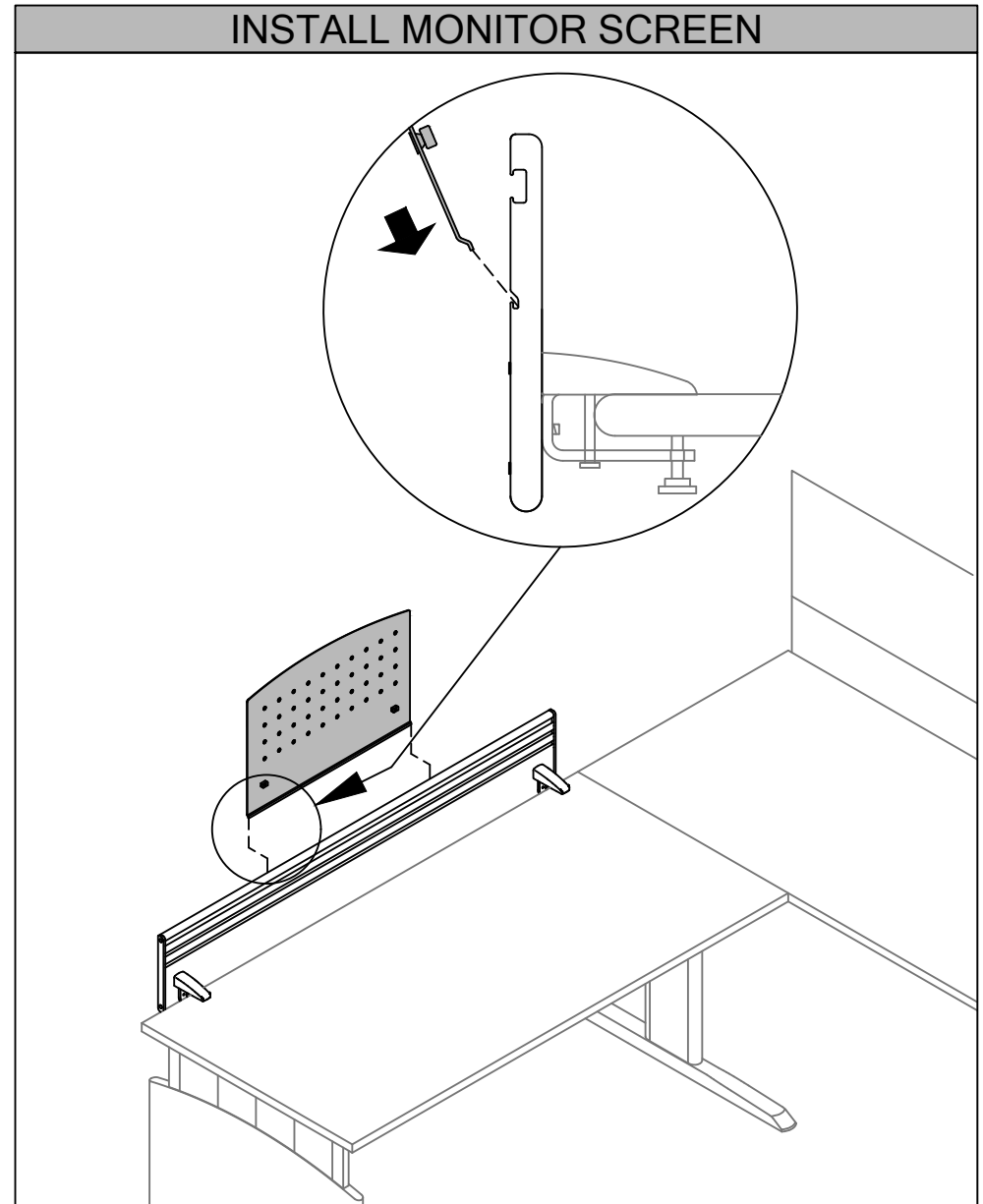

STEP 2: Install Monitor Screen by sliding Monitor Screen in the slot of back of Table Rail as shown above.

SECURE MONITOR SCREEN

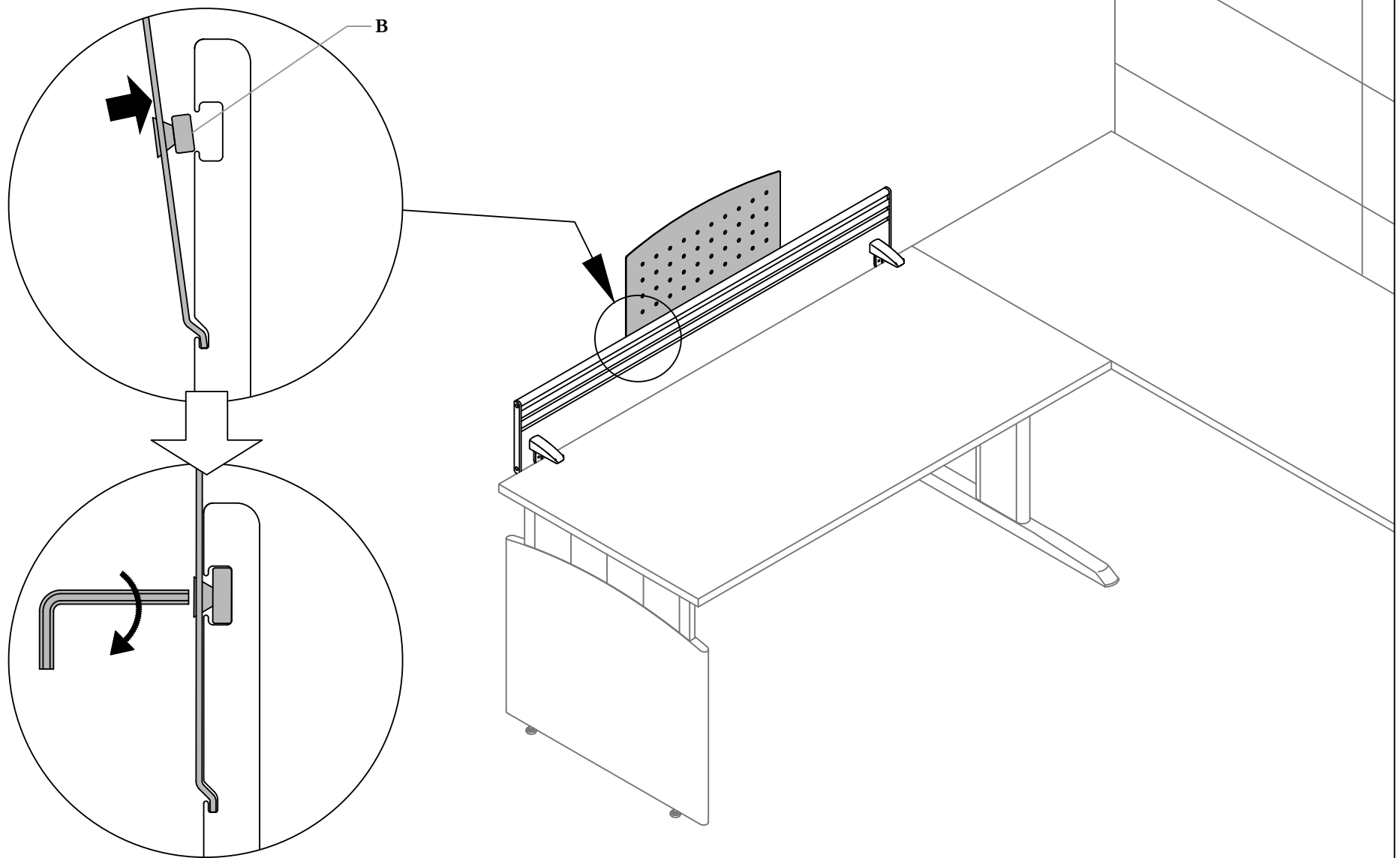

STEP 3: Secure and lock Monitor Screen with Allen Key as shown above.