

trine



studio T<

## Trine product information

The Trine Stool, designed by Estudi Manel Molina, was inspired by the classic and iconic three-legged milking stools used on farms in Spain. Manel combined his experiences of growing up on a farm and his artisanal background to create an alluring stool that is as simple as it is complex. Trine takes fabric, metal, and wood to produce a breathtaking design where a unique metal base and footrest seamlessly intertwine with metal or wooden legs. Trine's three sizes, a dining height, a bar height, and a counter height, combined with Studio TK's multiple textiles, wood finishes, and powder coating options, bring flair to all residential, hospitality, and workplace applications.

<b>Designer</b>	<b>Typology</b>
Estudi Manel Molina	Stool
<b>Collection</b>	<b>Year</b>
Studio TK	2023

### Collection



### Fabrics & Finishes

#### Upholstery

Seat can be finished in fabrics available from Luum, Maharam & Kvadrat; COM/COL

#### Wood Finishes

Basque White Oak, Sierra, Cocoa Brown, Truffle, Natural Oak

#### Metal Frame Finishes

Fundamental and Fashion powdercoat finishes available.

### Dimensions

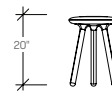
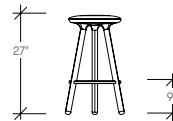
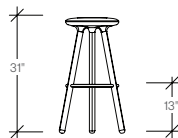
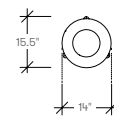
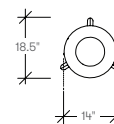
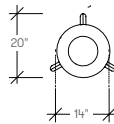

Trine Stool,  
Bar Height  
(TKCSM1/TKCSW1)

Trine Stool,  
Counter Height  
(TKCSM2/TKCSW2)

Trine Stool,  
Dining Height  
(TKCSM3/TKCSW3)

\* Dining Height does not  
have foot ring

#### Studio TK

3940 US 70 Business Hwy, West  
Clayton, North Carolina 27520, USA  
Tel: 855.941.0262 / Fax: 919.464.2927  
www.studiotk.com

©, TM Trademarks of teknon corporation and/or its subsidiaries or licensed to it. Patents may be pending. Some products may not be available in all markets. Contact your local Studio TK representative for availability.  
CAN/US/INT 05-23 © Teknion 2023 Printed in Canada SS-095-0101EN