

# lookbook

teknion expansion casework+

## 02

Expansion Casework+ surpasses industry standards, engineered for quality and durability. Consistent construction quality ensures every product is manufactured with precision and uniformity for a superior fit and finish. Thoughtful design elements allow easy reconfiguration, relocation, and simple installation.

Instantly access the full lookbook and assets library with all the high-resolution images and resources you need :



Flipbook



Assets library



# CAFÉ & DINING

## Cafeteria

04



Footprint : 23'-0" x 9'-6" (excluding dining area)

Laminate Grade 2 : Spruce - Laminates : Coastal Elm & Greystone

Metal : Accent Soft Gold



Cafeteria space footprint : 20'-6" x 2'-0" (excluding dining area) – Coffee area footprint : 7'-0" x 2'-0"

Laminates : Mercurial Walnut & Greystone

Metal : Foundation Crisp Grey

# CAFÉ & DINING

## Cafeteria



06

Footprint : 20'-0" x 2'-0" (excluding dining area and waste recycling center)

Laminate : Craft Walnut

Metals : Foundation Ebony & Accent Blue Sage



Footprint : 23'-6" x 2'-0" (excluding dining area and waste recycling center)

Laminate : Basalt Walnut

Metal : Foundation Greystone

## CAFÉ & DINING

### Cafeteria



Footprint : 13'-6" x 9'-6" (excluding dining area)

Laminate Grade 2 : Fjord - Laminates : Coastal Elm & Atrium White

Metal : Foundation Atrium White





09

Footprint : 14'-0" x 2'-0" (excluding dining area)

Laminate : Smoked Oak – Backpainted Glass : Soft Black

Metal : Accent Soft Gold

CAFÉ & DINING

Breakout Area



10

Footprint : 10'-0" x 2'-0"

Laminates : Essential Walnut & Ebony

Metal : Foundation Ebony

CAFÉ & DINING

Breakout Area



11

Footprint : 8'-0" x 6'-0" (excluding dining area)

Laminates : Basalt Walnut & Sand

Metal : Foundation Sand

## CAFÉ & DINING

### Breakout Area



12

Footprint : 13'-6" x 9'-6" (excluding seating and waste recycling center)

Laminate Grade 2 : Black Matte – Laminates : Northern Ash & Atrium White

Metal : Foundation Soft Black

CAFÉ & DINING

Breakout Area



13

Footprint : 11'-0" x 2'-0" (excluding dining area)

Laminate : Essential Oak

Metal : Mica Warm Nickel

## CAFÉ & DINING

### Refreshments Space



Footprint : 13'-6" x 10'-0" (excluding seating, workstations and meeting areas)

Laminates : Essential Oak & Atrium White

Metal : Foundation Atrium White

CAFÉ & DINING  
Refreshments Space



15

Footprint : 7'-6" x 4'-6" (excluding meeting and lounge areas)  
Laminates : Craft Walnut & Atrium White  
Metal : Accent Boreal

CAFÉ & DINING

Refreshments Space

16



Footprint : 9'-0" x 2'-0"

Laminate : Smoked Oak

Metal : Foundation Soft Black



CAFÉ & DINING  
Refreshments Space



17

Footprint : 8'-0" x 2'-0" (per area)  
Laminate : Atrium White  
Metal : Foundation Soft Black

RESIDENTIAL

Linear Kitchen with Island



18

Footprint : 14'-6" x 10'-0" (excluding seating)

Laminate Grade 2 : Clay Matte - Laminate : Craft Walnut

Metal : Foundation Clay - Backpainted Glass : Clay

RESIDENTIAL  
Walk-In Pantry

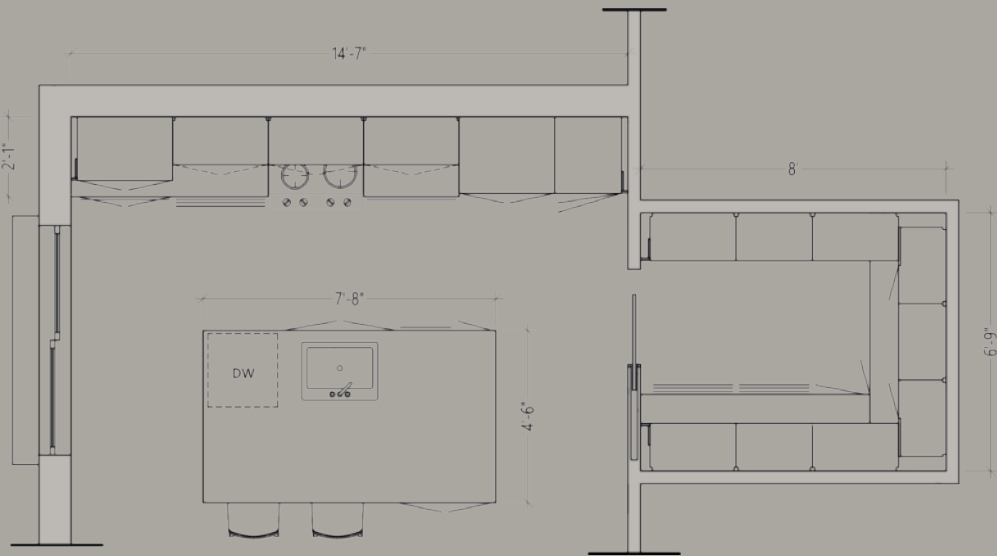

Footprint : 6'-9" x 8'-0"  
Laminate Grade 2 : Clay Matte - Laminate : Craft Walnut  
Metal : Foundation Clay

RESIDENTIAL

Linear Kitchen with Island

20



Footprint : 14'-0" x 9'-0" (excluding seating)

Laminates : Basalt Walnut, Storm White & Clay

Metals : Foundation Storm White Matte & Mica Graphite

RESIDENTIAL

Wet Bar

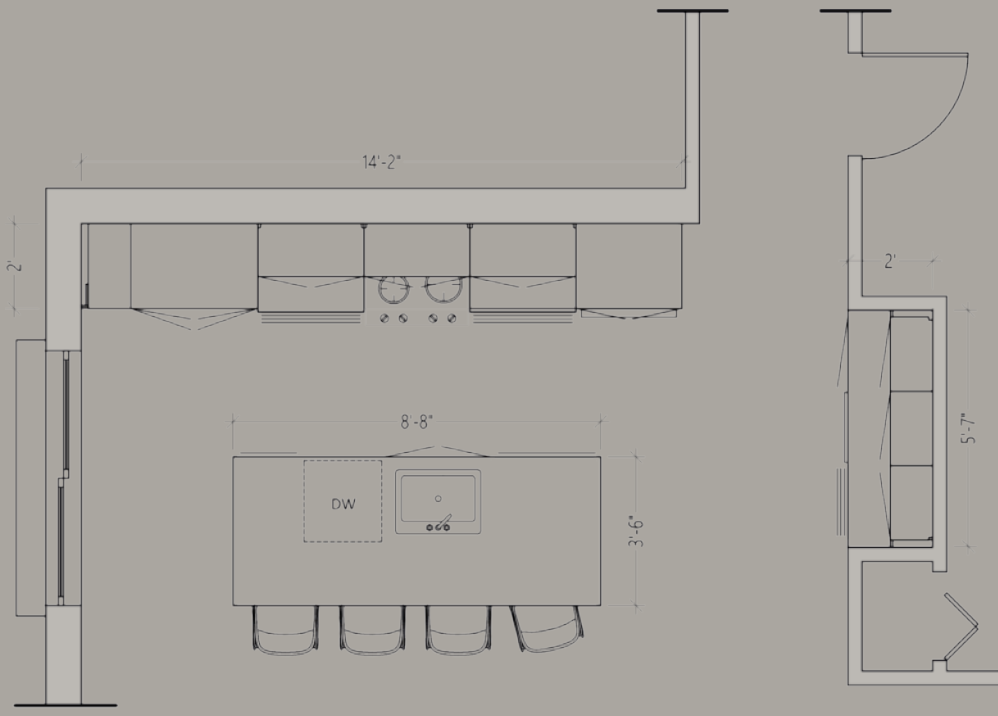

21

Footprint : 5'-6" x 2'-0"  
Laminate : Basalt Walnut  
Metal : Mica Graphite

RESIDENTIAL  
Linear Kitchen



22

Footprint : 17'-0" x 2'-0" (excluding dining and desk areas)

Laminate : Coastal Elm

Metal : Foundation Soft Black

RESIDENTIAL

Linear Kitchen with Island



23

Footprint : 10'-6" x 9'-0" (excluding seating)

Laminates : Smoked Oak & Greystone

Metal : Foundation Greystone

RESIDENTIAL

L-Shaped Kitchen

24



Footprint : 11'-0" x 8'-6" (excluding dining and living room areas)

Laminates : Coastal Elm & Atrium White

Metal : Foundation Atrium White



RESIDENTIAL

L-Shaped Kitchen with Island



25

Footprint : 12'-6" x 8'-0" (excluding seating)

Laminates : Craft Walnut & Greystone

Metal : Foundation Greystone

RESIDENTIAL

U-Shaped Kitchen



Footprint : 10'-0" x 15'-0"

Laminate Grade 2 : Spruce - Laminate : Essential Oak

Metal : Foundation Atrium White

RESIDENTIAL  
U-Shaped Kitchen



27

Footprint : 12'-0" x 8'-8" (excluding seating)  
Laminates : Essential Walnut & Atrium White  
Metal : Accent Soft Gold

## COMMON SPACES

### Lounge Area

28



Footprint : 12'-6" x 2'-0" (excluding lounge area)

Laminates : Greystone & Essential Walnut

Metal : Foundation Greystone



29

Footprint : 12'-6" x 2'-0" (excluding meeting area)  
Laminate Grade 2 : Black Matte – Laminate : Essential Walnut  
Metal : Foundation Soft Black

# COMMON SPACES

## Resources Library

30



Footprint : 18'-6" x 11'-0" (excluding seating)

Laminates : Ivory Birch & Atrium White

Metal : Mica Sepia Bronze

COMMON SPACES  
Collaboration Area



Footprint : 7'-8" x 4'-6" per island (excluding seating)  
Laminate Grade 2 : Black Matte - Laminate : Essential Oak  
Metal : Accent Boreal

## COMMON SPACES

### Resources Center



Footprint : 12'-6" x 13'-0" (excluding seating and workstations area)

Laminate Grade 2 : Black Matte - Laminate : Craft Walnut

Metal : Foundation Greystone





33

Footprint : 12'-0" x 7'-0"

Laminates : Essential Walnut & Sand

Metal : Mica Gilded Ash

## COMMON SPACES

### Learning Room

34



Footprint : 15'-0" x 2'-0" per area (excluding learning space)

Laminate Grade 2 : Black Matte - Laminate : Essential Oak

Metals : Foundation Greystone & Ebony



35

Footprint : 7'-6" x 2'-0" (excluding lounge area)

Laminate Grade 2 : Clay Matte – Laminate : Coastal Elm

Metal : Foundation Clay

HEALTHCARE

Patient Room

36



Footprint : 4'-0" x 2'-0" (excluding patient area)

Laminates : Crisp Grey & Soft Gris

Metal : Stainless (pulls only)

HEALTHCARE  
Consultation Room



Footprint : 8'-0" x 4'-6" (excluding consultation area)  
Laminates : Provincial Oak & Atrium White  
Metal : Foundation Atrium White

# HEALTHCARE

## Exam Room

38



Footprint : 12'-0" x 2'-0" (excluding desk and consultation areas)

Laminate : Coastal Elm

Metal : Foundation Crisp Grey



Footprint : 17'-0" x 2'-0" (excluding seating)  
Laminates : Coastal Elm & Atrium White  
Metal : Foundation Clay

CAFÉ & DINING



03



04



05



06



07



08



09



10



11



12



13



14



15



16



17

RESIDENTIAL



18



19



20



21





22



23



24



25



26



27

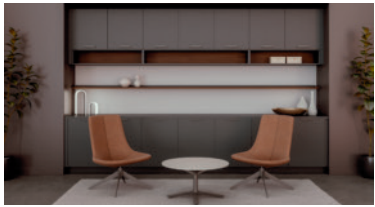

28



29



30



31



32



33



34



35



36



37



38



39

RESIDENTIAL - suite -

COMMON SPACES

HEALTHCARE

PULLS



Slim Pull



Edge - Small Pull



Stainless Pull (ADA)



Modern Straight Pull  
(ADA)



Edge - Standard Pull



Finger Pull



Rectangular Pull



Standard Expansion Pull

\*Drilled On-Site - No Pull option is also available  
(not shown)

LAMINATE WOODPRINT FINISHES (HPL & LPL)



Ivory Birch  
textured

2X (HPL)  
3X (LPL)



Choice Maple

2D (HPL)  
3D (LPL)



Campus Oak

2F (HPL)  
3F (LPL)



Essential Oak  
textured

7S (HPL)  
8S (LPL)



Pecan Reflect

2K (HPL)  
3K (LPL)

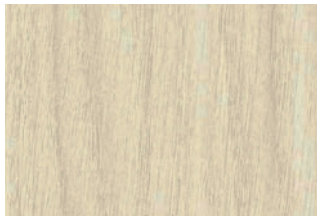

Northern Ash  
textured

7U (HPL)  
8R (LPL)

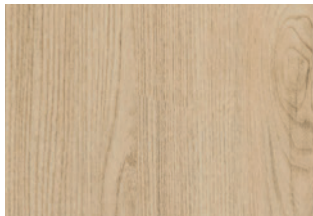

Coastal Elm  
textured

2L (HPL)  
3L (LPL)

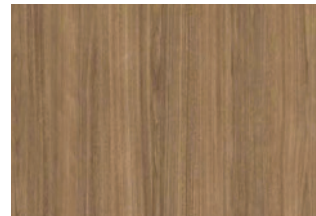

Craft Walnut  
textured

7Z (HPL)  
8B (LPL)

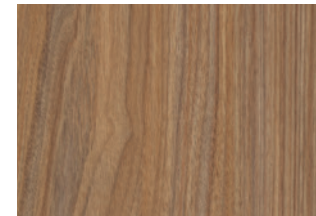

Mercurial Walnut

2A (HPL)  
3A (LPL)

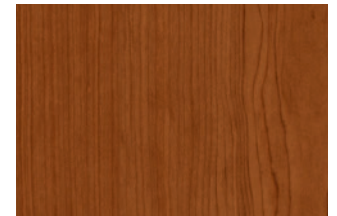

Estate Cherry

2E (HPL)  
3E (LPL)

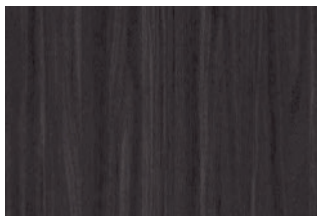

Basalt Walnut  
textured

7V (HPL)  
87 (LPL)

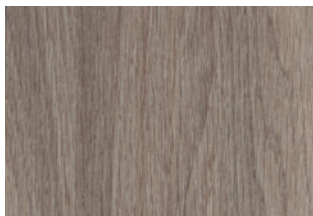

Provincial Oak  
textured

2M (HPL)  
3M (LPL)

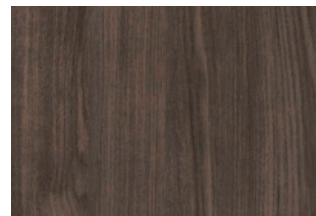

Smoked Oak  
textured

7B (HPL)  
86 (LPL)

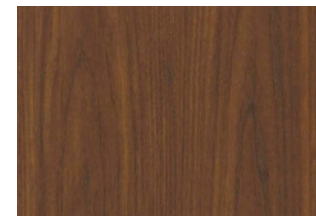

Essential Walnut  
textured

7M (HPL)  
8E (LPL)

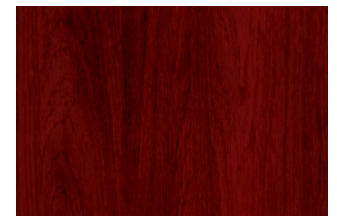

Royal Cherry

YR (HPL)  
XR (LPL)

Instantly access the full lookbook and assets library with all the high-resolution images and resources you need :

Flipbook



Assets library



Expansion Casework+ is available on CET

For any inquiries, please contact our team :

[trb.technical@teknion.com](mailto:trb.technical@teknion.com)

US 1.877.835.6466

CAN 1.888.297.3494

# teknion

expansion casework+ lookbook  
volume 1

[teknion.com](http://teknion.com)

can/us/int 01-25

© Teknion 2025

®, ™ trade marks of Teknion Corporation  
and/or its subsidiaries or licensed to it.  
Patents may be pending.

For regional product availability please  
contact your Teknion representative.

Colors represented within this piece are  
digital and intended to provide a  
reference of finish options. Refer to  
individual samples to view actual color  
and material.

Printed in Canada. BR-Casework1-EN