

height-adjustable bench  
(asia pacific)

price & application guide

02.24.2025



teknion



# update summary

Please be advised that information has been updated within the Height-Adjustable Bench (Asia Pacific). To highlight these updates a summary has been created for your reference.

## UPDATE

The country of the installation USA (05) have been update to Japan (05) on the following product:

- hiSpace 2 Frame (MHHABFLV)

Please note, first orders for new products will be accepted on February 24, 2025. All software will also be updated by February 24, 2025. If you have any questions regarding the information enclosed, please contact your Teknion Customer Service Representative.







INTRODUCTION . . . . .	6
HISPACE APPLICATION GUIDES . . . . .	13
HEIGHT ADJUSTABLE TABLE . . . . .	17
HISPACE 2 APPLICATION GUIDES . . . . .	21
HISPACE 2 FRAMES . . . . .	37
HISPACE 2 WORKSURFACES . . . . .	41
HISPACE 2 CASUAL SPACE DIVISION . . . . .	45
HISPACE 2 WIRE MANAGEMENT . . . . .	51

introduction

---

# where to find the information you need

**Teknion provides an array of tools and information resources to help you get things done simply and easily. From product pricing to application guidelines to online planning suggestions, you will find what you need when you need it.**

## guide contents

This guide contains all the information you need to order this product through your specification software. The Introduction section provides everything you need to get started, including an index for product reference. The Application Guide section contains detailed specification guidelines, application and planning information to help you plan your project correctly. The Price Guide sections provide detailed pricing and specification information by product type. Available online at [www.teknion.com](http://www.teknion.com).

---

## where to find the information you need

All Teknion marketing materials are available online at [www.teknion.com](http://www.teknion.com), including:

price & product guide

application guide

planning tool

installation guides

fabrics & finishes

product photography & drawings

weights & volumes

order forms

warranty/terms & conditions of sale

xpress program guide

---

## teknion forms

The following forms are available online at [www.teknion.com](http://www.teknion.com), to help you specify and place your order if required:

### teknipaint

If you require a custom paint color match, you must submit a TekniPaint form.

### using your own material (COM)

If you wish to use your own material on fabric-covered products, you must submit a completed COM form including a sample upholstery and safety testing. A COM Order Information Sheet must also be submitted. This form captures all relevant ordering and tracking information. A COM Request for Yardage Calculation form may be sent to Teknion for preliminary yardage requirements.

### placing a manual order

Complete an Order Cover Sheet with the information we need to fill your order. This is the most important step. If the Order Cover Sheet is not complete and correct, the order may be delayed.

---

## key requirements

If you require that certain pieces share the same locks you will need to specify Set of Keys Alike (SOKL) located in the Price and Product Guide.

---

## user feedback

How is our marketing material working for you?

Feedback from the user is very important to the quality of Teknion's marketing material. We ask that if you have suggestions on how you think we could improve content OR if you have found an error, that you contact your Teknion Technical Services department.





Section Content	Product Code	Page No.
<b>INTRODUCTION</b>		
Where to find the information you need		7
What is hiSpace 2 & hiSpace Height-Adjustable Bench		10
Height-Adjustable Range		11
<b>HISPACE APPLICATION GUIDE</b>		
Height-Adjustable Table Planning with Electrics & Wire Management		15
<b>HEIGHT-ADJUSTABLE TABLE</b>		
Cable Tray	MYSCT	19
<b>HISPACE 2 APPLICATION GUIDE</b>		
Understanding Hispace 2 Height-Adjustable Bench Frames		23
Frame Basics		24
Planning with Frames		25
Worksurface Basics		26
Planning with Worksurfaces		28
Casual Mid and End Covers		30
Fixed Centre Screen Basics		31
Planning with Actual vs. Nominal Casual Screen		32
Planning with Casual Fixed Center Screens		33
Base Feed Basics		34
Planning with Base Feeds		35
<b>HISPACE 2 FRAMES</b>		
hiSpace 2 Frame	MHHABFLV	38
hiSpace 2 Frame Link	MHHABFLF	39
<b>HISPACE 2 WORKSURFACE</b>		
hiSpace 2 Frame Rectangular Worksurface	MHHABWRL	42
<b>HISPACE 2 CASUAL SPACE DIVISION</b>		
Fixed Center Screen – Fabric	MHHABCF F	46
hiSpace 2 Side Cover – Metal	MHHABCEM	47
hiSpace 2 Cable Tray Cover – Metal	MHHABFCC	48
<b>HISPACE 2 WIRE MANAGEMENT</b>		
hiSpace 2 Vertical Wire Carrier	MHHABEEC	52
hiSpace 2 Base Feed Cover	MHHABEBC	53
hiSpace 2 Worksurface Cable Tray	MHHABWCT	54
hiSpace 2 Power Access Door	MHHABPAD	55
Felt Cover Cable Organizer	MYEYA	56

## what is hispace 2 height-adjustable bench

**Height-Adjustable Bench creates benching workspaces that provide users individual control of their work and movement.**

### hiSpace 2

- Single or linked stations create a benching environment that fully supports user sit/stand ranges, technology requirements, and a high level of flexibility to create individual privacy
- A wide product and finish offering allows Height-Adjustable Bench to be planned at multiple price points.

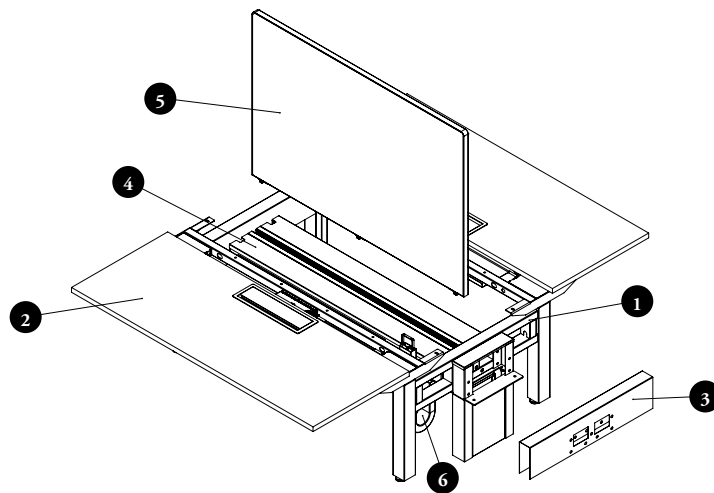

#### height-adjustable bench 2 workstations must include

- ① Frame
- ② Worksurface x 2
- ③ End Covers or End Gables x2 (End Cover Shown)

#### height-adjustable bench 2 workstations can include

- ④ Cable Tray Cover
- ⑤ Screening (Desk Edge / Fixed)
- ⑥ Electrical (Vertical Wire Carrier)

The Height-Adjustable Bench 2 is made up of a simple kit of parts including Frames, End Covers & Gables, Worksurfaces, Screens and Wire Management.

# height-adjustment range

Height-adjustment range of tables varies depending on which table option is selected.

## height-adjustment chart

The following chart shows weight capacity and adjustment ranges for each mechanism.

	Weight Capacity	Maximum Height (A)	Minimum Height (B)	Adjustment Range (C)
<b>hiSpace</b>				
Sit to Stand Electric (9E)	200lbs (90kg)	127cm	63.5cm	63.5cm
Technician Adjustment	150lbs (68kg)	86cm	56cm	30.5cm

## certifications & approval

Height-adjustable tables is certified to the following standards.

CERTIFICATION	COUNTRY
UL	USA
CE	Europe
KC	Korea
RCM	Australia

hispace  
application guides

# hispace application guides

HEIGHT-ADJUSTABLE TABLE

HEIGHT-ADJUSTABLE TABLE PLANNING WITH ELECTRICS

& WIRE MANAGEMENT . . . . . 15





# height-adjustable table planning with electrics & wire management

A number of Complements power and wire management components are available for use with hiSpace. The following outlines the planning recommendations for each.

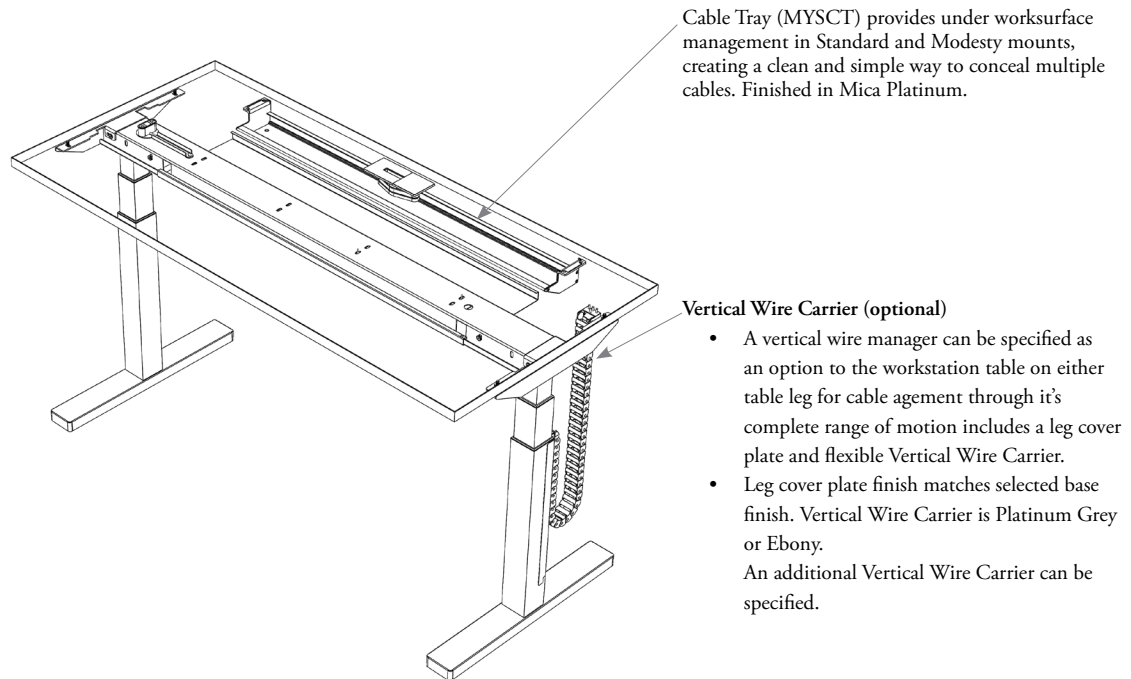

Standard version cable trays are specified the width of the workstation table however, the actual size is 457cm shorter than the nominal, to avoid leg and bracket interference. Modesty version cable trays are specified the width of the modesty panel that they are being attached to.

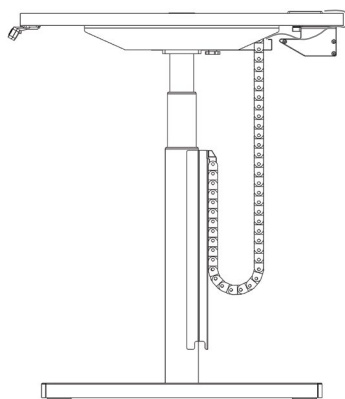

The Standard version of the cable tray mounts to the underside of the worksurface to manage cables.

height-adjustable table

**MYSCT    Cable Tray**

Page 19

Width: 100cm, 110cm, 120cm, 140cm, 150cm,  
160cm, 180cm







This product can be installed under workstation tables for cable management, with or without the presence of a modesty panel.

## MYSCT Cable Tray

### WHAT'S INCLUDED

1 cable tray with mounting hardware.

### NOTES

Standard (S) mount style width to be specified to match the table width. Actual tray will be 48.2cm less than width specified.

Tray is finished in Mica Platinum.

Dimensions referenced are nominal – actual dimensions: width -5.1cm, depth -2.5cm.



### PRODUCT OPTIONS

Mounting	Width
S Standard	10, 11, 12, 14, 15, 16, 18

### SAMPLE ORDER CODE

MYSCT S	12
---------	----

### DIMENSION CODE / CM

### PRICING

W	Standard
10/100	273
11/110	286
12/120	299
14/140	311
15/150	321
16/160	335
18/180	346

hispace 2  
application guides

# hispace 2 application guides

## FRAMES

UNDERSTANDING HISPACE 2 HEIGHT-ADJUSTABLE	
BENCH FRAMES . . . . .	23
FRAME BASICS . . . . .	24
PLANNING WITH FRAMES . . . . .	25

## WORKSURFACES

WORKSURFACE BASICS . . . . .	26
PLANNING WITH WORKSURFACES . . . . .	28

## CASUAL SPACE DIVISIONS

CASUAL MID AND END COVERS . . . . .	30
FIXED CENTRE SCREEN BASICS . . . . .	31
PLANNING WITH ACTUAL VS. NOMINAL CASUAL	
SCREENS . . . . .	32
PLANNING WITH CASUAL FIXED CENTER SCREENS . . . .	33

## ELECTRICS

BASE FEED BASICS . . . . .	34
PLANNING WITH BASE FEEDS . . . . .	35



# understanding hispace 2 height-adjustable bench frames

hiSpace 2 Height-Adjustable Bench can be specified with one frame providing a two person workstation or in runs with multiple connected frames, in Standard and Extended Range electric mechanisms.

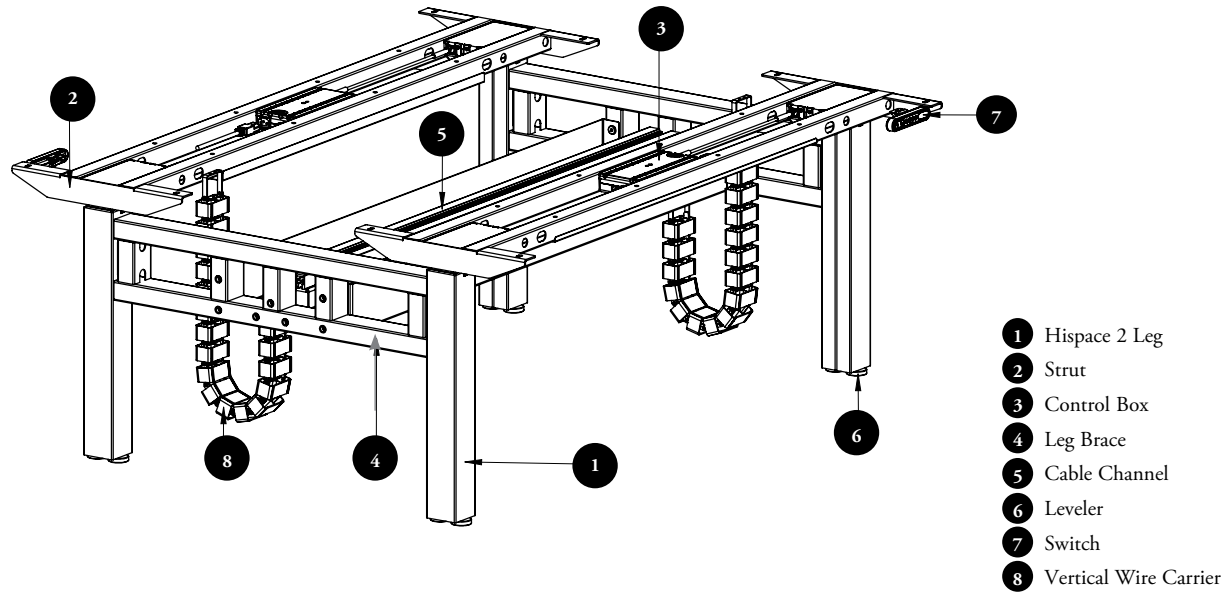

## height-adjustment ranges

Each section of a bench can only have one height adjustment range, however it can vary from section to section as each frame is independent although linked.

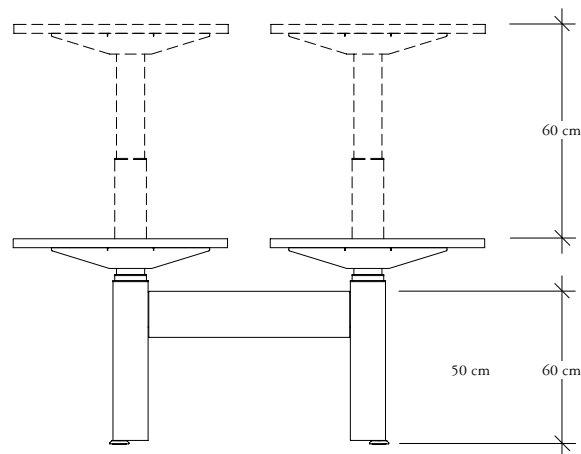



## frame basics

**hiSpace 2 Height-Adjustable Bench begins with a hiSpace 2 Frame which can be linked to additional frames. Each frame section accommodates two users.**

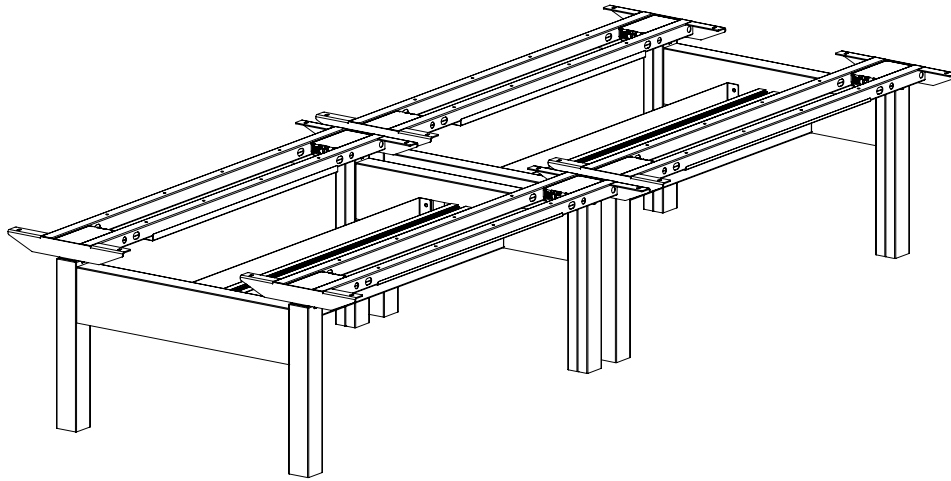

hiSpace 2 Frame, Standard Range and End & Mid Covers.

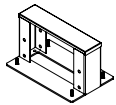

### **hiSpace 2 Frame Link (MHHABFLF)**

- Used to connect two frames together
- Contains two brackets, 1 package is required for each bench connection
- The link is concealed by Mid Covers and Mid Gables
- Finished in Ebony



### **hiSpace 2 Vertical Wire Carrier (MHHABEEC)**

- Mounts to the cable tray of the frame below to conceal & manage all harnesses, wiring and data & communication cables
- Available in Ebony, Platinum and Very White

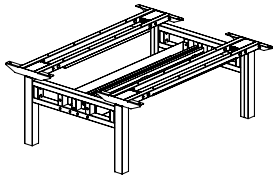

### **hiSpace 2 Frame (MHHABFLV)**

- Used with two rectangular worksurfaces to create a bench
- Available in depths of 120cm, 140cm and 160cm and widths of 120cm, 140cm, 150cm, 160cm, 180cm
- Available in Standard Range (60cm – 125cm) or electric mechanisms
- 1cm leveling capability
- Display switch has three programmable settings and a cool blue display screen with digital capability
- Available in Ebony, Platinum and Very White finishes

# planning with frames

The following should be considered when planning with Frames.

## frame depths

hiSpace 2, 120cm, 140cm and 160cm depth Frames use the same frame structure so are identical in depth. The overall bench depths are achieved through the depths of the worksurface.

120cm Frame depth

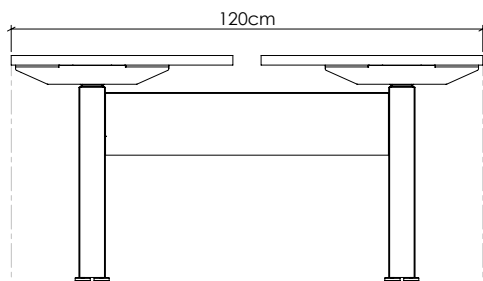

140cm Frame depth  
(Same frame as 120cm depth frame, but with deeper worksurfaces)

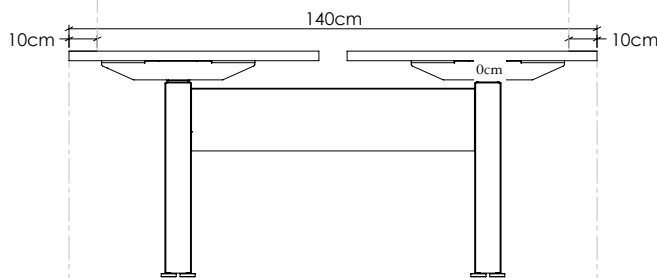

160cm Frame depth

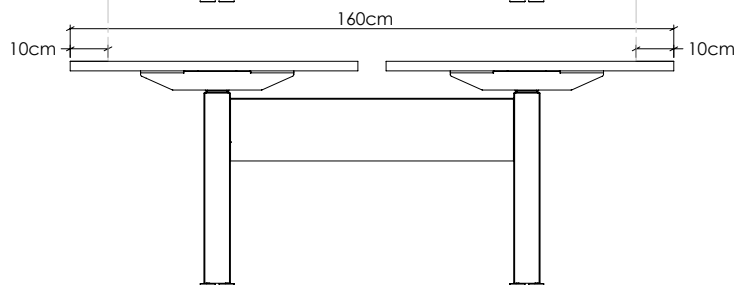

## leveling

- hiSpace 2 Height-Adjustable Bench Frames allow for 1cm of leveling. When more than 1cm of leveling is required, a break in the bench run is necessary
- A site check prior to order is required to determine floor levels

## worksurface basics

hiSpace 2 Rectangular Worksurfaces are available with a 7.5cm or 15cm center gap to accommodate casual screens.

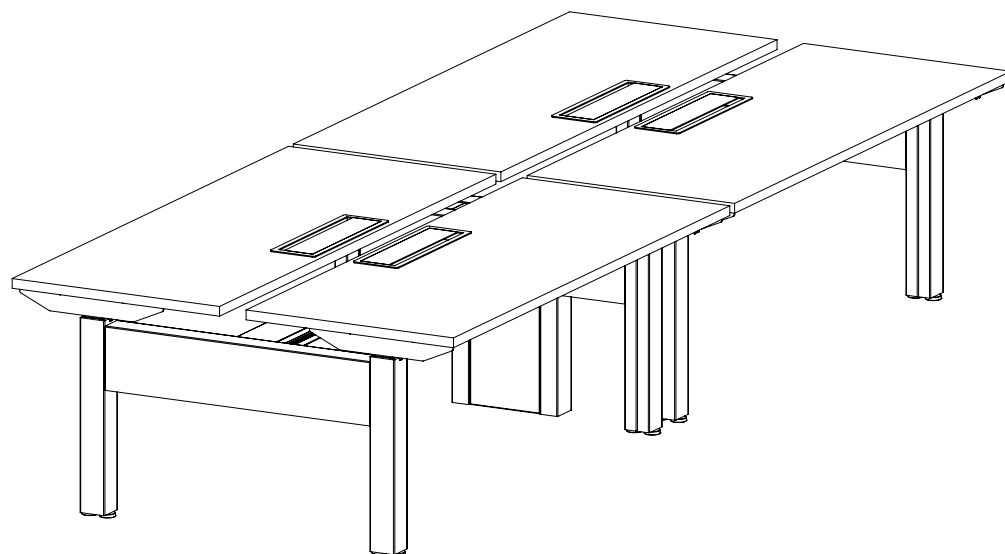

hiSpace 2 Rectangular Worksurface  
with 7.5cm gap shown

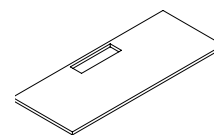

### hiSpace 2 Rectangular Worksurface (MHHABWRL)



- Worksurfaces are sized to match hiSpace 2 worksurface widths
- Available in depths of 60cm, 70cm and 80cm and widths of 120cm, 140cm, 150cm, 160cm and 180cm increments to match the frame widths
- All depths are nominal; actual depths are either 3.8cm less to allow for fixed center screens see screen section for screen details
- All widths are nominal; actual widths are 2.5cm less to allow a 2.5cm gap on each side to prevent pinch points
- Electrical Grommet options and additional locations available

# hispace 2 application guides

---

## worksurface basics (continued)

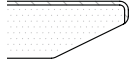
### edge profiles

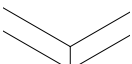
		Source Laminate	Foundation Laminate Surface
Full Knife (H)			✓
Straight Trim (6) User Edge		✓	✓
Straight User Edge		✓	✓

# hispace 2 application guides

## planning with worksurfaces

The following should be considered when planning with hiSpace 2 Rectangular Worksurfaces.

### depths and widths

Worksurface depths and widths are nominal.

#### Depths

Actual depths are 37.5cm less to provide a 7.5cm gap between face to face users for space division.

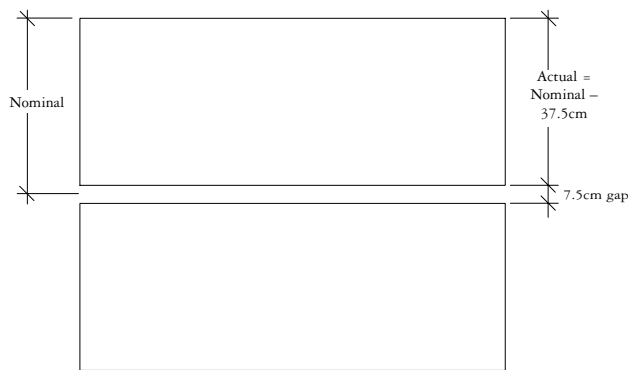

#### Widths

The actual width is 2.5cm less than the nominal width to allow for a 1.25cm gap on each side of the surface for height-adjustable safety precautions. This results in a 2.5cm gap between lateral worksurfaces.

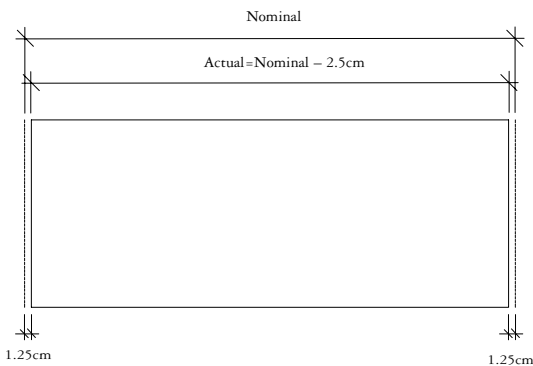

### edge profiles

Full Knife edge details are only on the user side. Non-user edges are always Straight Trim.

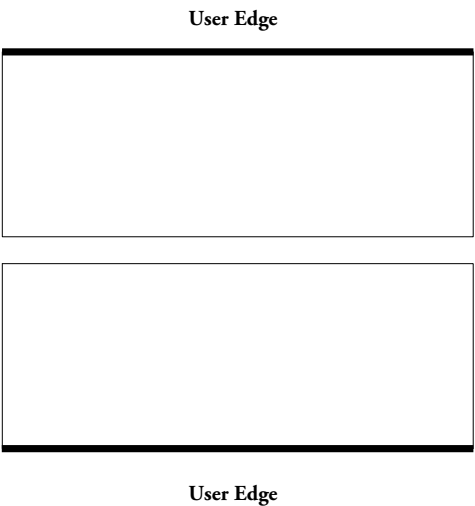



# hispace 2 application guides

## planning with worksurfaces (continued)

### grommets

- Two cut out options are available:
  - Central Electrical Grommet
  - Pass through grommet
- Pass-Trough Grommets are available left, right and/or center, the Central Electrical Grommet is only available in the center

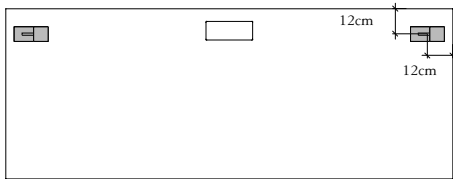

#### Pass Through

- Grommets are 12cm on centre from both edges
- When a Center Electrical Grommet is specified a pass through grommet cannot go in the center location

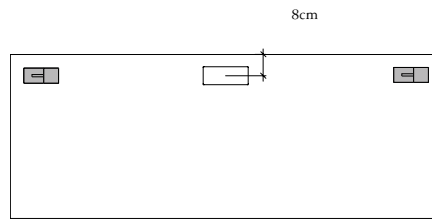

#### Flip up

- Central Electrical Grommet centered 8cm on center from the back edge

### Flip up options



400mm

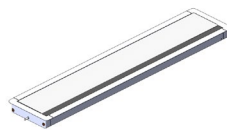

600mm

### Pass through Grommet



Available in Platinum

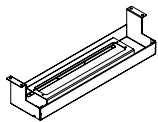

### hiSpace 2 Worksurface Cable Tray (MHHABWCT)

- When Flip up is specified, Cable Tray need to be purchase separately
- Cable Tray comes with a cut out for 6 gang netbox rail as default
- Netbox rail o be purchase separately

# hispace 2 application guides

---

## casual mid and end covers

Casual Mid and End Covers are available to conceal the exposed leg brace of the Frame.

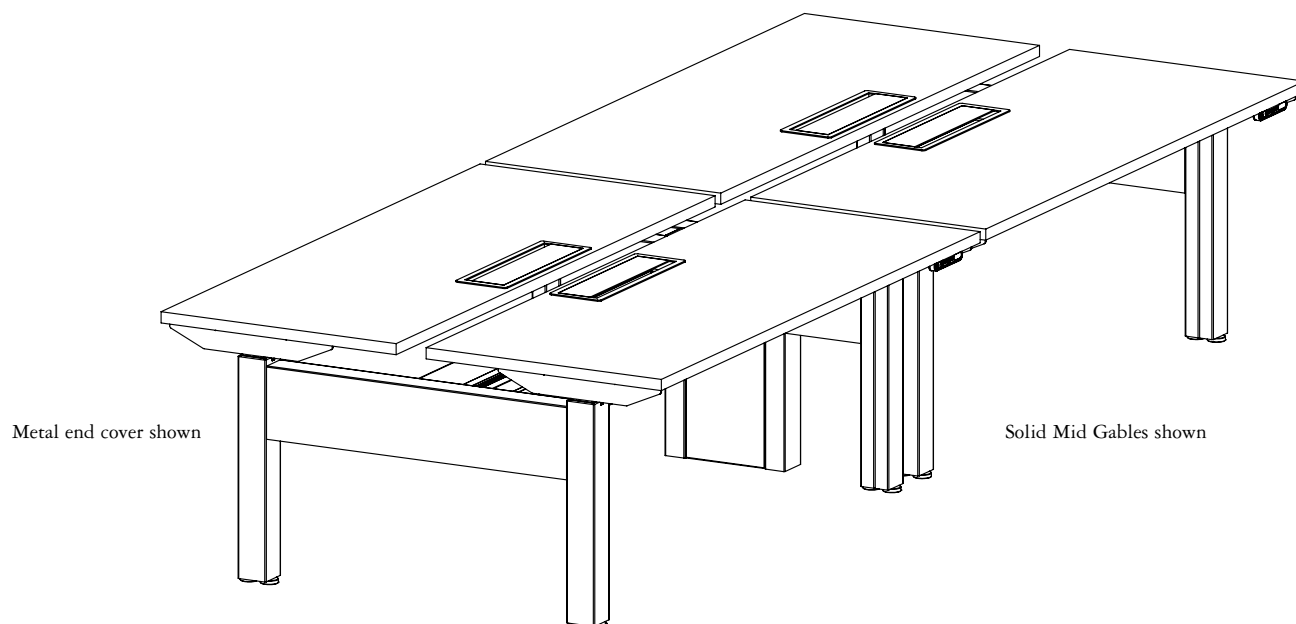

- **Covers** conceal the end and mid leg braces

### metal

Metal Covers and Gables are available in Ebony, Platinum and Very White

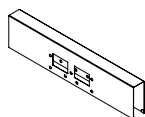

#### hiSpace 2 End Cover – Metal (MHHABCEM)

- End cover comes without Cable Channel Provision
- Mid Cover comes with Cable Channel Provision

# fixed centre screen basics

Two casual Screens options are available for hiSpace 2 Height-Adjustable Bench; Desk Edge Screens and Fixed Center Screens, each provide privacy between users.

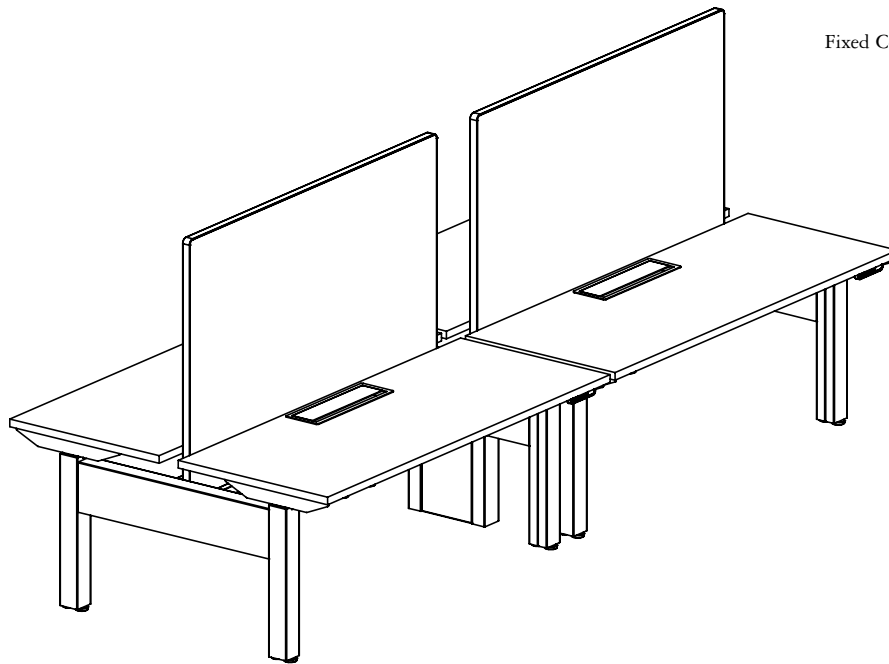

Fixed Center Screen shown 130cm datum

## fixed center screens

- Mount to the accessory beam on a Cable Channel to provide privacy and space division
- A 7.5cm gap between worksurfaces must be specified
- Available 86cm high to achieve a 130cm height datum when mounted to the accessory Beam
- Available in fabric glass and solid finishes

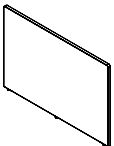

### hiSpace 2 Fixed Center Screen – Fabric (MHHABCF)

- Available in:
  - Panel fabric COM, Gr. A, Gr. AA, Gr. 1-3
- Screen always has a 18.2cm Inset, 9.1cm each side

planning with actual vs. nominal casual screens

The following chart outlines the Nominal vs. Actual width of Fixed Center Screens.

Fixed Center Screens - Inset

Nominal Widths	Actual Widths
120cm	99.3cm
140cm	119.3cm
150cm	129.3cm
160cm	139.3cm
180cm	159.3cm

# hispace 2 application guides

## planning with casual fixed center screens

The following should be considered when planning with Casual Fixed Center Screens.

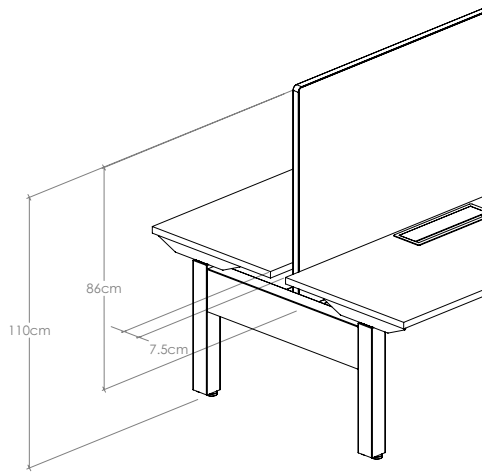

The Fixed Center Screen is 86cm h and has an overall 130cm datum height. Must be used with worksurfaces with a 7.5cm gap.

### actual vs. nominal dimension

When specifying fixed center screens, it is important to consider the nominal vs. actual sizing.

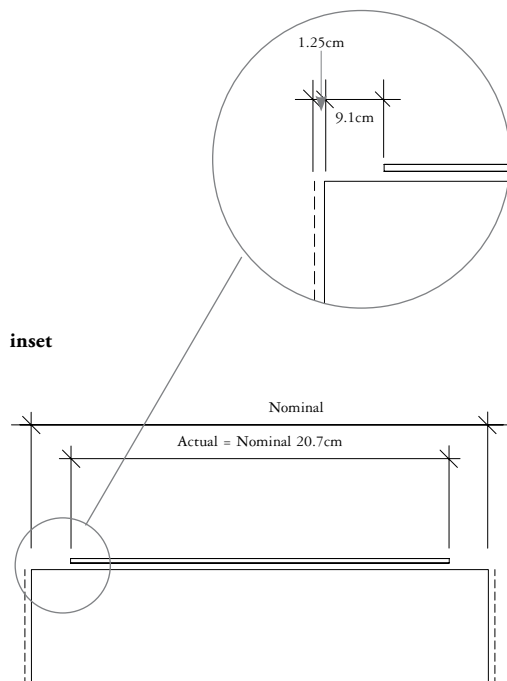

The inset Fixed Center Screen is 9.1cm less than the work surface width on each side. Worksurfaces also have a 1.25cm gap on each side so the overall actual width is 20.7cm less than the nominal width.

## base feed basics

**Power and Data enter hiSpace 2 Height-Adjustable Bench from the ceiling through a Power Pole and Ceiling Feed or from the floor with a Base Feed.**

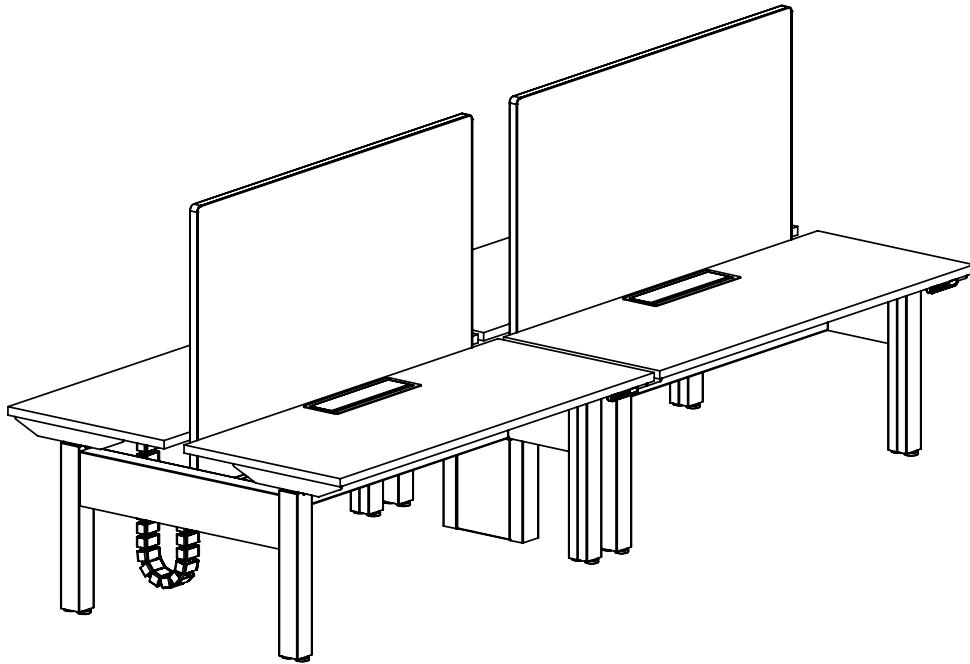

### base feed

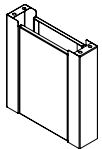

#### **hiSpace 2 Base Feed Cover (MHHABEBC)**

- Used to route power and data cables into a workstation from the floor
- Available in Ebony, Platinum and Very White

The following should be considered when planning with Base Feeds.

### base feed covers

#### end cover – metal

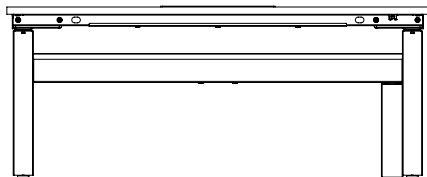

When the Base Feed Cover-End Condition is specified, it includes a floor to Cable Channel cover and a cover plate finished to match the Cable Channel.

#### mid cover – metal

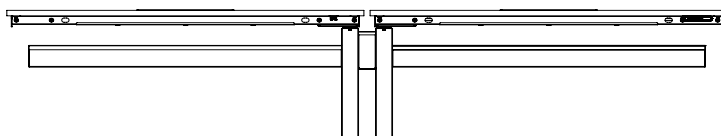

When Mid Condition is specified it is accommodated by reversing the mounting bracket and facing the opening towards the Cable Channel Provision in the hiSpace 2 Mid Cover-Metal.

hispace 2 frames



### MHHABFLV hiSpace 2 Frame

Page 38

Depth: 60cm, 70cm, 80cm

Width: 120cm, 140cm, 150cm, 160cm

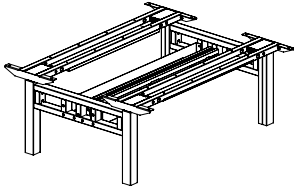

### MHHABFLF hiSpace 2 Frame Link

Page 39

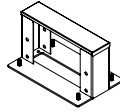

## M H H A B F L V hiSpace 2 Frame

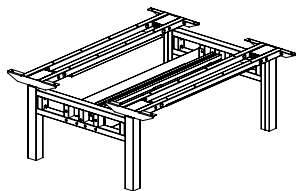

The hiSpace 2 Frame is used with 2 hiSpace 2 Rectangular Worksurfaces to create a hiSpace 2 Height-Adjustable Bench station.

### WHAT'S INCLUDED

Each frame includes 2 electric height-adjustable mechanisms, 2 switches, 4 height-adjustable legs, 2 leg braces, 2 center support channels, 4 levelers and 1 center structure.

### NOTES

Requires 2 Hispace 2 Rectangular Worksurfaces (MHHABWRL).

7.6cm of leveling.

Standard Range Electric has a height adjustment range from 60cm to 125cm.

Display Switch has 3 programmable settings and a cool blue display screen with diagnostic capabilities.

All electrical base mechanisms have a 0.1 Watt resting power draw.

### PRODUCT OPTIONS

Base Mechanism	Depth	Width	Finish	Finish
7 Standard Range Electrics (60-125cm)	12, 14, 16	12, 14, 15, 16, 18	83 Very White 60 Platinum 52 Ebony	01 GB 02 Schuko 03 EU 04 Thailand 05 Japan 06 Australia 08 China 09 India 3 Pin 10 Philippines 11 Indonesia

### SAMPLE ORDER CODE

MHHABFLV 7	12	14	83	01
------------	----	----	----	----

### DIMENSIONS CODE / CM

### PRICING

D	W	Standard
12 / 120	12 / 120	6757
12 / 120	14 / 140	6771
12 / 120	15 / 150	6786
12 / 120	16 / 160	6800
12 / 120	18 / 180	6815
14 / 140	12 / 120	6757
14 / 140	14 / 140	6771
14 / 140	15 / 150	6786
14 / 140	16 / 160	6800
14 / 140	18 / 180	6815
16 / 160	12 / 120	6757
16 / 160	14 / 140	6771
16 / 160	15 / 150	6786
16 / 160	16 / 160	6800
16 / 160	18 / 180	6815

The Frame Link is used to join one hiSpace 2 Height-Adjustable Bench to another hiSpace 2 Height-Adjustable Bench.

## WHAT'S INCLUDED

Frame links, assembly hardware.

## M H H A B F L F hiSpace Frame Link

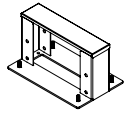

## PRODUCT OPTIONS

Finish
83 Very White
60 Platinum
52 Ebony

## SAMPLE ORDER CODE

MHHABFLF 83
-------------

## PRICING

163
-----

hispace 2 worksurfaces

**MHHABWRL hiSpace 2 Frame  
Rectangular Worksurface**

Page 42

Depth: 120cm, 140cm, 160cm

Width: 120cm, 140cm, 150cm, 160cm, 180cm

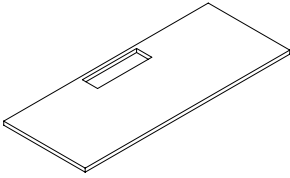

M H H A B W R L

hiSpace 2 Frame Rectangular Worksurface

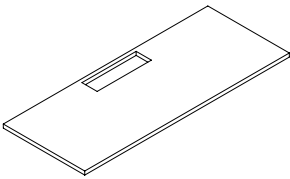

The hiSpace 2 Rectangular Worksurface is to be used on all hiSpace 2 Height-Adjustable Bench Stations.

**WHAT'S INCLUDED**  
1 worksurface.

**NOTES**  
Actual width is calculated as the stated nominal width is minus 2.5cm and depth is minus 1.25cm.  
Grommet (N) is available only if Access Door Cut-Out Size is (04) and (06) are specified.  
Grommet C, L, R, and B is available only if Access Door Cut-Out Size is (NN) are specified.  
Grommet finish is not available if Grommet (N) are specified.  
If access door is chosen, only cut out is provided. The access door need to be purchased separately.

PRODUCT OPTIONS

Depth	Width	Access Door Cut-Out Size	Grommet
12 120cm	12 120cm	NN None	N No Grommet
14 140cm	14 140cm	04 40cm	C Grommet Center
16 160cm	15 150cm	06 60cm	L Grommet Left
	16 160cm		R Grommet Right
	18 180cm		B Both Left & Right

SAMPLE ORDER CODE

MHHABWRL 12	14	NN	C
-------------	----	----	---

PRODUCT OPTIONS (CONTINUED)

Surface Finish	Edge Trim Style	Grommet Finish
Source Laminate	6 Straight Trim	83 Very White
Foundation Laminate	H Full Knife Edge (Applicable for Foundation Laminate only)	60 Platinum
		52 Ebony

SAMPLE ORDER CODE (CONTINUED)

YQ	6	83
----	---	----

Pricing is continued on the following page.

**M H H A B W R L**  
**hiSpace 2 Frame Rectangular**  
**Worksurface (continued)**

**DIMENSIONS**  
**CODE / CM**
**PRICING**

D	W	SOURCE LAMINATE	FOUNDATION LAMINATE	FOUNDATION LAMINATE
		Straight Edge	Straight Edge	Knife Edge
12 / 120	12 / 120	328	363	510
12 / 120	14 / 140	415	460	643
12 / 120	15 / 150	429	479	675
12 / 120	16 / 160	442	491	687
12 / 120	18 / 180	502	558	783
14 / 140	12 / 120	384	428	597
14 / 140	14 / 140	473	526	737
14 / 140	15 / 150	490	548	770
14 / 140	16 / 160	503	559	785
14 / 140	18 / 180	606	673	942
16 / 160	12 / 120	439	490	686
16 / 160	14 / 140	551	611	856
16 / 160	15 / 150	565	631	888
16 / 160	16 / 160	580	643	902
16 / 160	18 / 180	696	773	1082

If Grommet is specified, add following upcharges to the Price;

Left (L) or Right (R) or Center (C)	add	76
Both Left & Right (B)	add	154

hispace 2  
casual space division



**MHHABCFF hiSpace 2  
Fixed Center  
Screen – Fabric**

Page 46  
Height: 130cm  
Width: 120cm, 140cm, 150cm, 160cm, 180cm

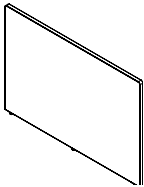

**MHHABCEM hiSpace 2 Side  
Cover – Metal**

Page 47  
Depth: 120cm, 140cm, 160cm

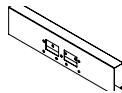

**MHHABFCC hiSpace Cable  
Tray Cover – Metal**

Page 48  
Depth: 120cm, 140cm, 150cm, 160cm, 180cm

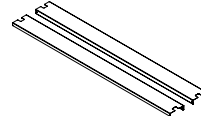

# hispace 2 casual space division

M H H A B C F F

## hiSpace 2 Fixed Center Screen – Fabric

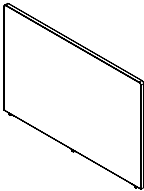

The hiSpace 2 Fixed Center Screen – Fabric attaches to the accessory beam element of the Cable Channel and provides casual privacy and space division.

**WHAT’S INCLUDED**

1 fabric screen and attachment hardware.

**NOTES**

130cm installed top screen height.

Actual Inset width is calculated as the stated nominal Inset width minus 00cm.

**PRODUCT OPTIONS**

Height	Width	Screen Finish	Finish
13	12, 14, 15, 16, 18	COM Grade A Grade 1 Grade 2 Grade 3	<b>83</b> Very White <b>60</b> Platinum <b>52</b> Ebony

**SAMPLE ORDER CODE**

<b>MHHABCFF 13</b>	<b>12</b>	<b>B203</b>	<b>83</b>
--------------------	-----------	-------------	-----------

**DIMENSIONS  
CODE / CM**

**PRICING**

		PANEL FABRIC (P)			
W	H	Gr. AA/ COM	Gr. 1	Gr. 2	Gr. 3
13 / 130	12 / 120	812	835	879	905
13 / 130	14 / 140	917	944	986	1014
13 / 130	15 / 150	944	973	1014	1041
13 / 130	16 / 160	977	1005	1045	1072
13 / 130	18 / 180	1107	1140	1181	1207

hiSpace 2 End Cover – Metal attaches to and covers the Height-Adjustable Bench leg brace at the start or end of a run.

## WHAT'S INCLUDED

1 metal end cover and attachment hardware.

## NOTES

Side Cover does not wrap around the legs.

Mid type to be mounted at mid when connect to another bench. It comes with hole for wire pass through.

End type to be mounted at end.

## M H H A B C E M hiSpace 2 Side Cover – Metal

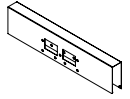

## PRODUCT OPTIONS

Depth	Type	Cover Finish
12, 14, 16	<b>1</b> Mid <b>2</b> End	<b>83</b> Very White <b>60</b> Platinum <b>52</b> Ebony

## SAMPLE ORDER CODE

<b>MHHABCEM 12</b>	<b>1</b>	<b>83</b>
--------------------	----------	-----------

## DIMENSIONS CODE / CM

## PRICING

D	MID TYPE	END TYPE
12 / 120	112	112
14 / 140	112	112
16 / 160	112	112

M H H A B F C C

hiSpace 2 Cable Tray Cover – Metal

Cable Tray cover the spine cable tray to hide the cables inside.

**WHAT'S INCLUDED**  
2 metal cover

**NOTES**  
Side to be ordered based hiSpace 2 workstation side

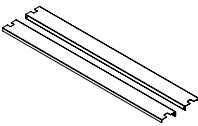

PRODUCT OPTIONS

Depth	Cable Channel Provision	Cover Finish
12, 14, 15, 16, 18	1 No	83 Very White 60 Platinum 52 Ebony

SAMPLE ORDER CODE

MHHABFCC 12	1	83
-------------	---	----

DIMENSIONS  
CODE / CM

PRICING

D	
12 / 120	272
14 / 140	308
15 / 150	317
16 / 160	328
18 / 180	371



hispace 2  
wire management

## product map

**MHHABEEC** hiSpace 2  
Vertical Wire  
Carrier

Page 52

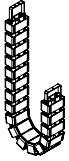

**MHHABEBC** hiSpace 2 Base  
Feed Cover

Page 53

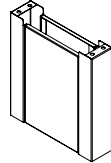

**MHHABWCT** hiSpace 2  
Worksurface Cable  
Tray

Page 54

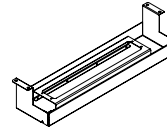

**MHHABPAD** hiSpace 2 Power  
Access Door

Page 55

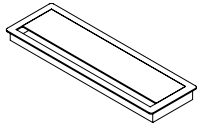

**MYEYA** Felt Cover Cable  
Organizer

Page 56

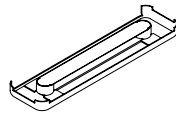

M H H A B E E C  
hiSpace 2 Vertical Wire Carrier

The Vertical Wire Carrier safely manages and conceals all vertical wires and cables.  
**WHAT'S INCLUDED**  
1 Vertical Wire Carrier with mounting hardware.

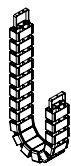

PRODUCT OPTIONS

Style	Finish
1 Standard Mount	60 Platinum 52 Ebony 83 Very White

SAMPLE ORDER CODE

MHHABEEC 1	52
------------	----

PRICING

269



Base Feed Cover is used to route power and data cables into the workstation from the floor.

WHAT’S INCLUDED

1 base feed cover mounting brackets and hardware.

NOTES

Base Feed Cover provides a route for cables and wires from the floor to the Cable Channel.

M H H A B E B C  
hiSpace Base Feed Cover

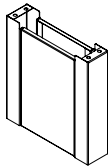

PRODUCT OPTIONS

Finish
83 Very White
60 Platinum
52 Ebony

SAMPLE ORDER CODE

MHHABEBC 83
-------------

PRICING

180
-----

M H H A B W C T  
hiSpace 2 Worksurface Cable Tray

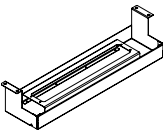

The Cable Tray with Separator provides discrete wire management with a capability for run cable below the power module.

**WHAT'S INCLUDED**  
1 cable tray and hardware

**NOTES**  
Tray is complete with holes which will allow for the mounting of Netbox Rail 6 Gang power Bars.  
Netbox to be purchased separately.

PRODUCT OPTIONS

Type	Access Door Cut-Out Size	Finish
U Under Worksurface	04 40cm 06 60cm	83 Very White 60 Platinum 52 Ebony

SAMPLE ORDER CODE

MHHABWCT U	04	83
------------	----	----

DIMENSIONS  
CODE / CM

PRICING

CUT OUT SIZE

04 / 40	219
06 / 60	221

The Power Access Door covers the cut out in the Power Cut Out Worksurface.

## WHAT'S INCLUDED

1 access door.

## NOTES

Flips up to allow access to the mounted receptacles below.

## M H H A B P A D hiSpace Power Access Door

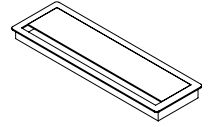

## PRODUCT OPTIONS

Size	Finish
<b>04</b> 40cm <b>06</b> 60cm	<b>83</b> Very White <b>60</b> Platinum <b>52</b> Ebony

## SAMPLE ORDER CODE

<b>MHHABPAD 04</b>	<b>83</b>
--------------------	-----------

## DIMENSIONS CODE / CM

## PRICING

### CUT OUT SIZE

04 / 40	208
06 / 60	247

MYEYA  
Felt Cover Cable Organizer

**WHAT'S INCLUDED**  
1 metal cable organizer spine, two wire looms and three velcro straps, felt cover (if specified), mounting hardware.

**NOTES**  
Not applicable if grommet and flip up is specified.

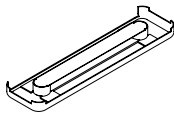

PRODUCT OPTIONS

Configuration
01 Small Cable Organizer-With Felt Cover
03 Large Cable Organizer-With Felt Cover

SAMPLE ORDER CODE

MYEYA 01
----------

CONFIGURATION	PRICING
CODE	
01	294
03	294



# teknion

[www.teknion.com](http://www.teknion.com)

CAN/US/INT 10-24  
©Teknion 2024

®, ™ trade marks of Teknion Corporation  
and/or its subsidiaries or licensed to it.  
Patents may be pending.

Some products may not be available in  
all markets. Contact your local Teknion  
Representative for availability.

OCT24-AIH-PG